

Parts List(Some parts have spare ones.)



Bag No. 1-a		Bag No. 1-b						
Item number	P1	P2	P3	P4	P5	P6	P7	P8
Item	Main control circuit board	Lamp panel 6	Lamp panel 1	Lamp panel 2	Lamp panel 3	Lamp panel 4	Lamp panel 5	Switch spring
Illustration								
Quantity	1	1	1	1	1	1	1	1

Bag No.2						
Item number	P9	P10	P11	P12	P13	P14
Item	Steel shaft	Steel shaft	Copper nail (golden)	Partition	Copper button	Screw (black)
Illustration						
Quantity	1	1	1	1	1	5

Bag No. 3			
Item number	P15	P16	P17
Item	Semi-permeable mirror	One-way mirror	Round sticker
Illustration			
Quantity	1	1	1

Bag No. 4	
Item number	P18
Item	Screw (silver)
Illustration	
Quantity	10

Bag No. X1	
Item number	P19
Item	Screw (black)
Illustration	
Quantity	4

Bag No. X2	
Item number	P20
Item	Ø8mm steel ball
Illustration	
Quantity	12

Bag L					
Item number	L1	L2	L3	L4	L5
Illustration					

Bag M					
Item number	M1	M2	M3	M4	M5
Illustration					

Bag N									
Item number	N1	N2	N3	N4	N5	N6	N7	N8	N9
Illustration									
							X2		X2

Bag Q				
Item number	Q1	Q2	Q3	Q4
Illustration				

Tools			
Power cord	Pliers	Screwdriver	Magnetic rod

WARNING

1. The product is not suitable for children under 3 years old.
2. The product contains small parts and electronic components. Adults should guide and supervise children in the correct use of the product to prevent ingestion or choking.
3. The product shall only be used with a transformer or a power supply for it.
4. The transformer or power supply is not a toy or model.
5. This product does not need to be cleaned with liquid, and please use a clean and soft dry cloth to wipe.
6. Keep the product away from the sources of ignition and keep it in dry place in case of the damage.
7. The power supply used with the electric toy shall be regularly examined for damage to the supply cord, plug, enclosure or other parts, and in the event of damage, it shall not be used until the damage has been repaired.
8. Do not connect the wire to the output socket.
9. The product is not to be connected to more than the recommended number of power supplies.
10. This product is only to be connected to equipment of Class II. 
11. The instruction must be retained since it contains important information.

ATTENTION

1. Don't use chemical reagents like alcohol and ammonia water to clean the product.
2. Take off the pieces from the board according to each step when assembling.
3. Cut the parts along the edge with cutting pliers and then grind them carefully with a sandpaper stick.
4. Please carefully read the instruction book when assembling and keep it properly for later verification.
5. For some complicated steps, please scan the QR code with remind for assembling videos.
6. There is a little difference between several parts and the pictures on instruction, subject to parts number.
7. Pieces marked "+" are spare parts on boards.
8. The QR code on the cover is the after-sales certificate, and please do not alter it.



Product Display

*CUSTOMER SERVICE

ROKR Facebook: @rokrofficial Email: service@robotime.com Please contact us on Facebook or email if you have any questions.

Instructions of using the pliers

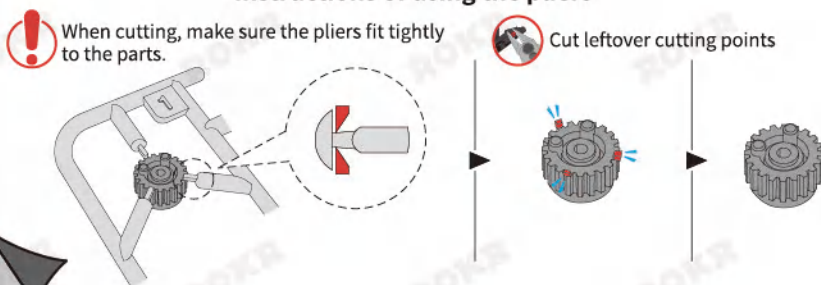

Icon Illustration



Gameplay Instruction

Lift module
(upward mechanism)

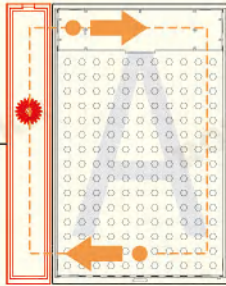

Marble run module
(downward mechanism)

The Parallel World products contain **marble run modules and lift modules**.
(The orange line is an illustration of the route of marble after assembling.)

1
<1>

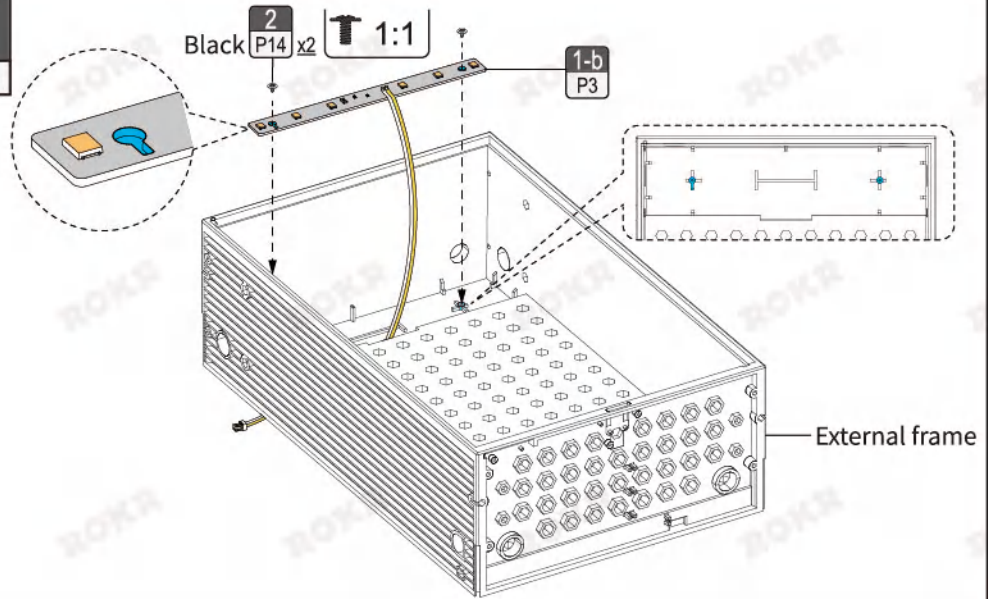

1
<2>

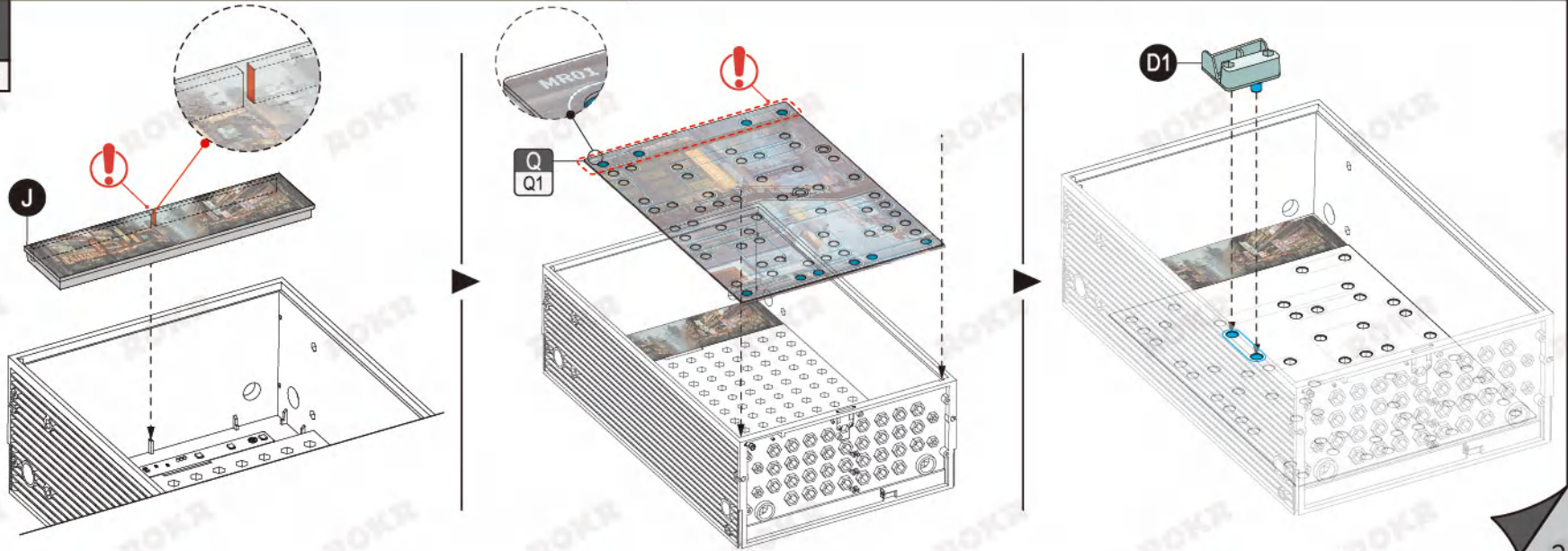

1

<3>

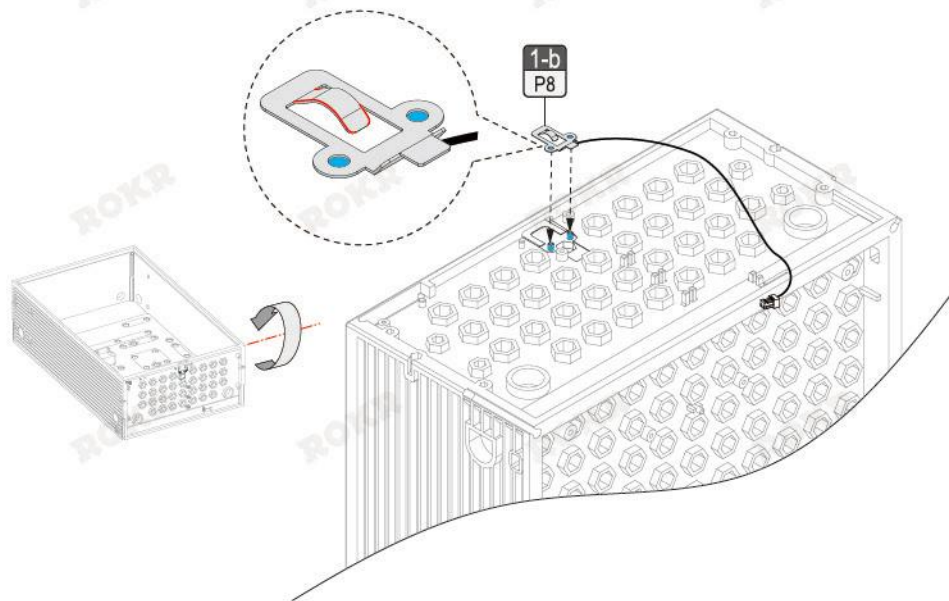
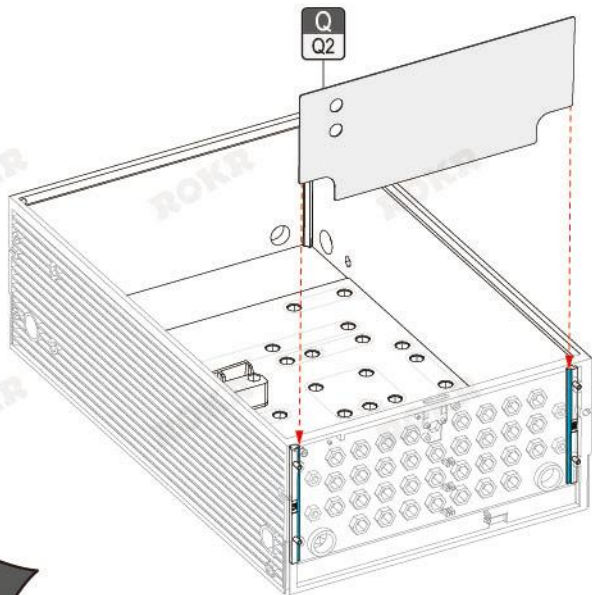
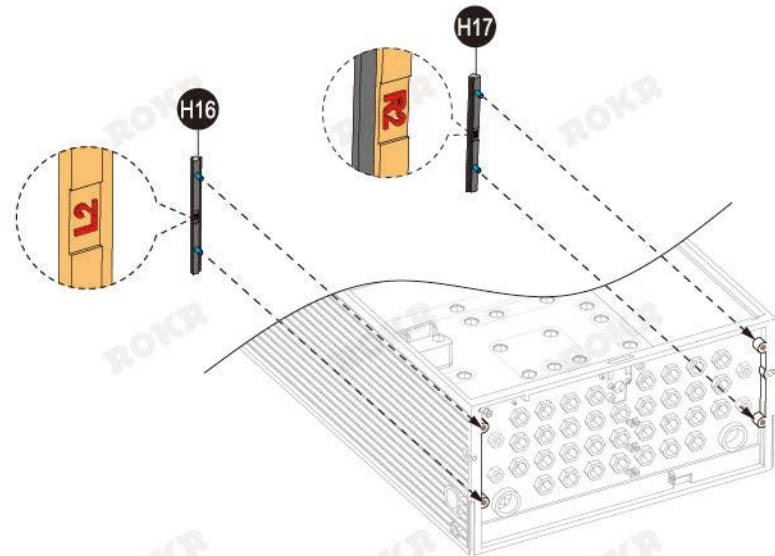
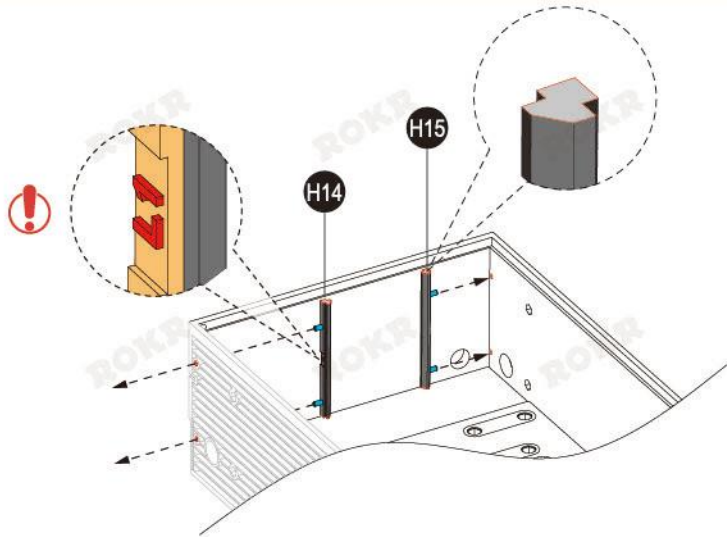

1

<4>

T 1:1
2 P14 x2
Black

H9

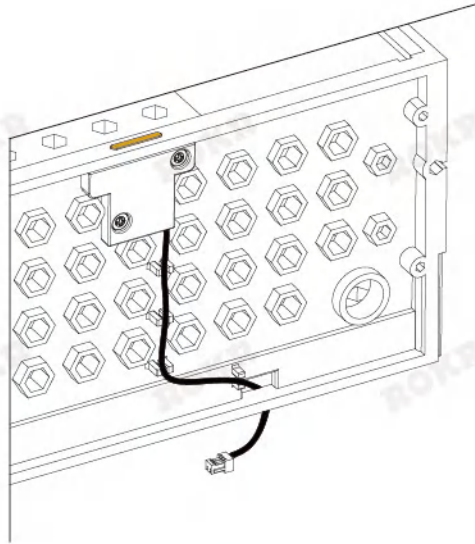
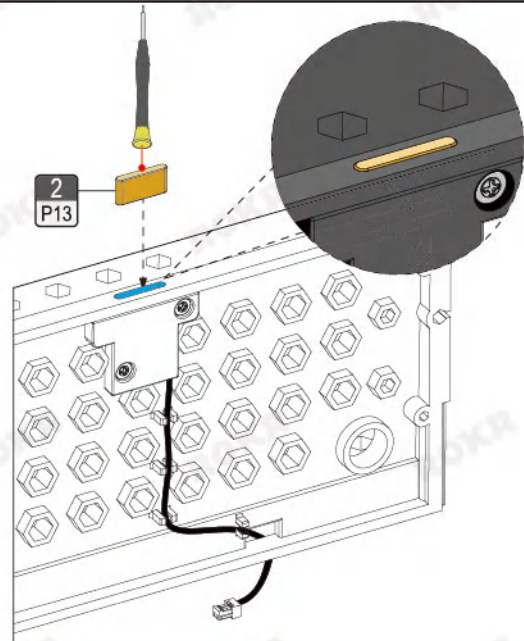
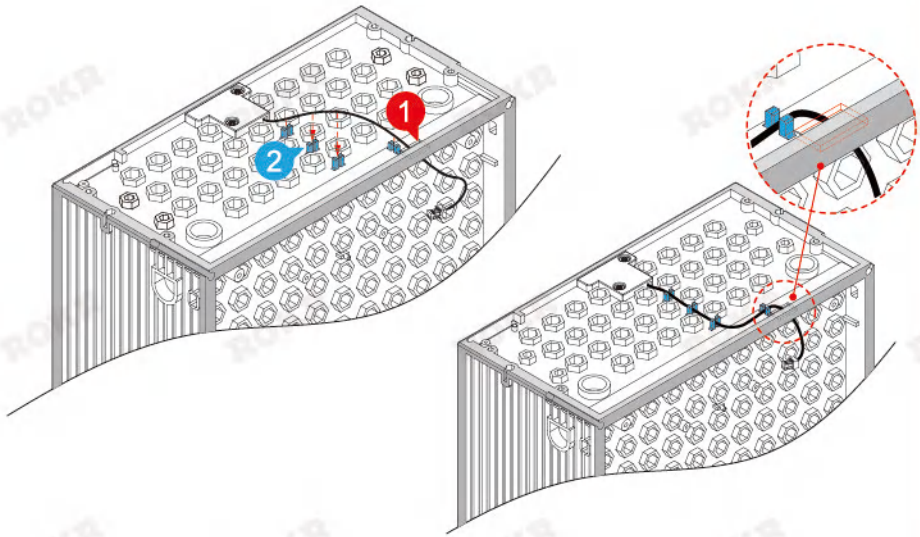
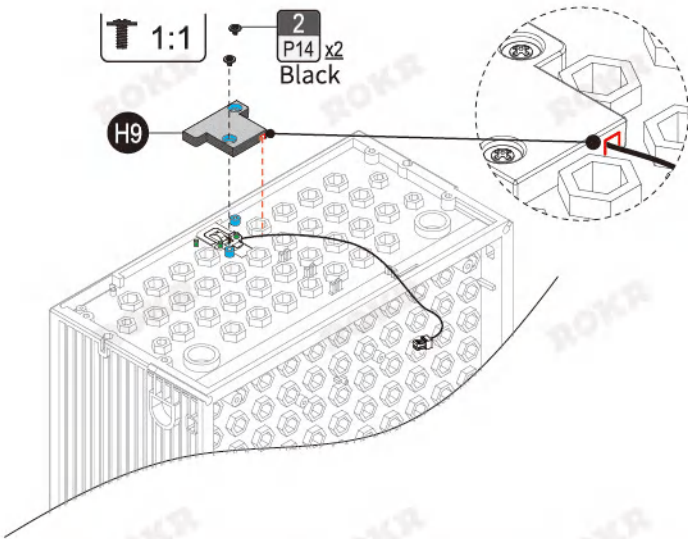

2

Completion

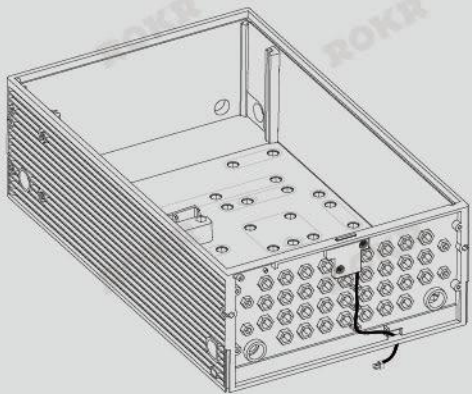

2

<1>

Notice before assembling:

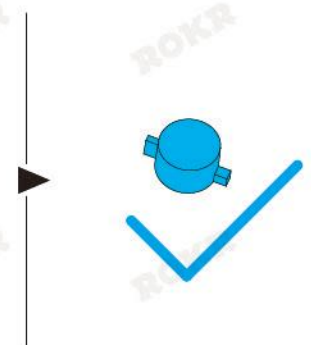
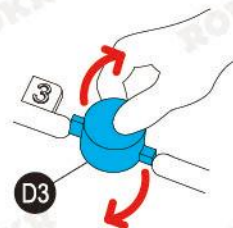

! Some parts can be hand-removed to avoid excessive cutting. When you see the icon , rotate the part by hand to remove it.

Basic Play

(Assembly instruction for A)

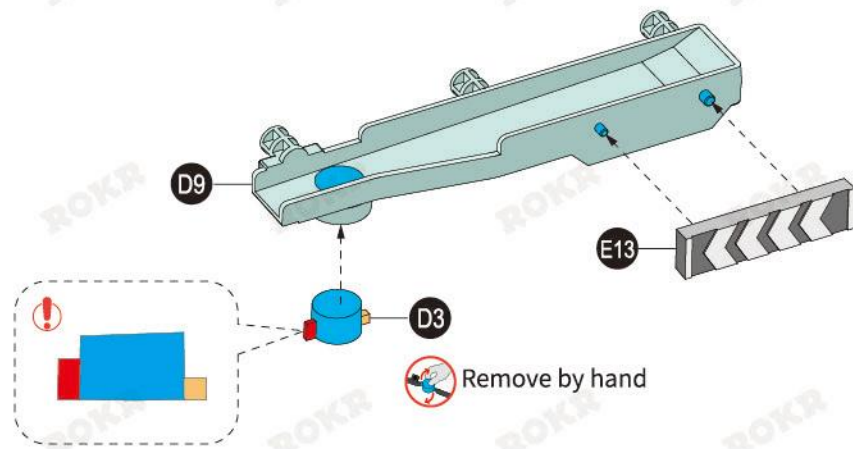
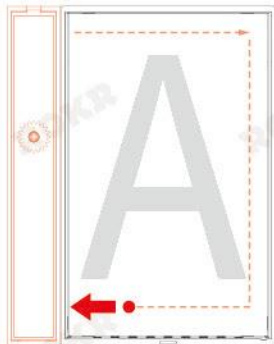
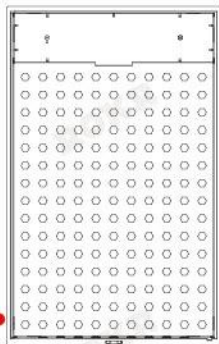

2

<2>

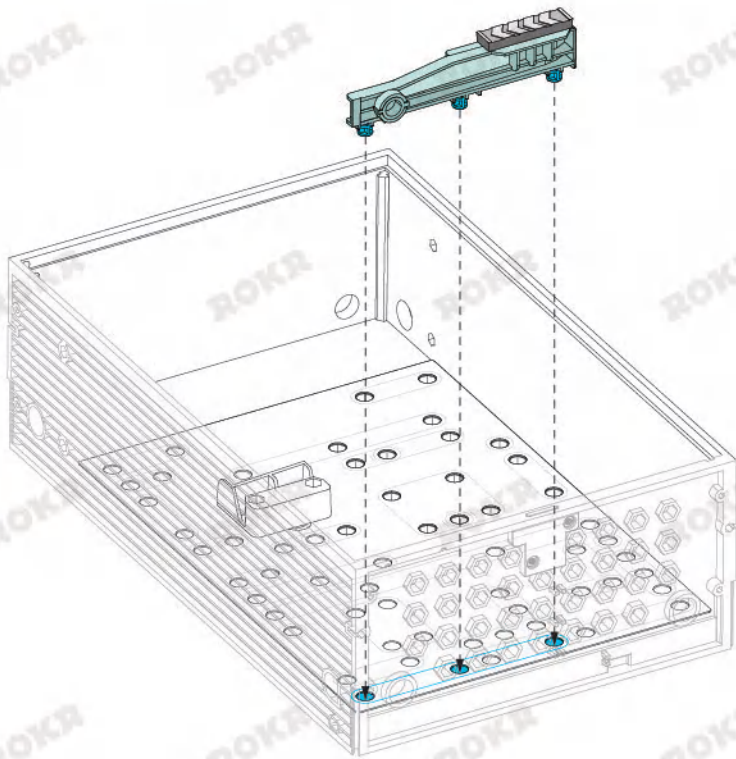
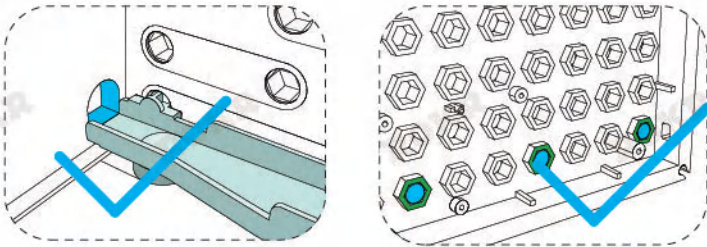

Advanced Play - Module Extension
(Skip it if not needed.)
(Assembly instruction for B)

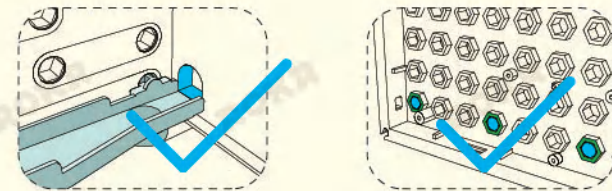
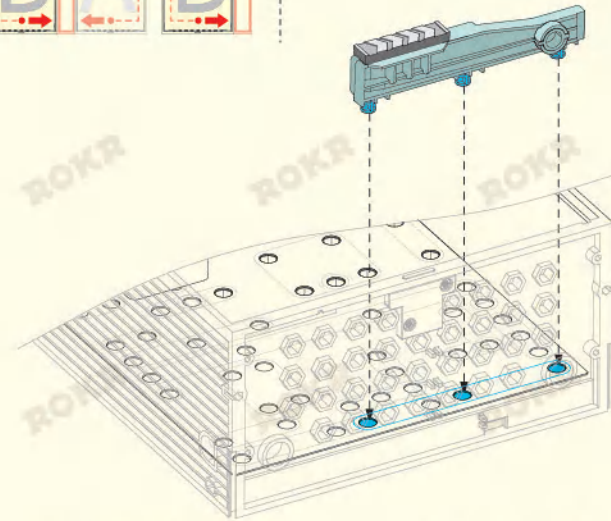
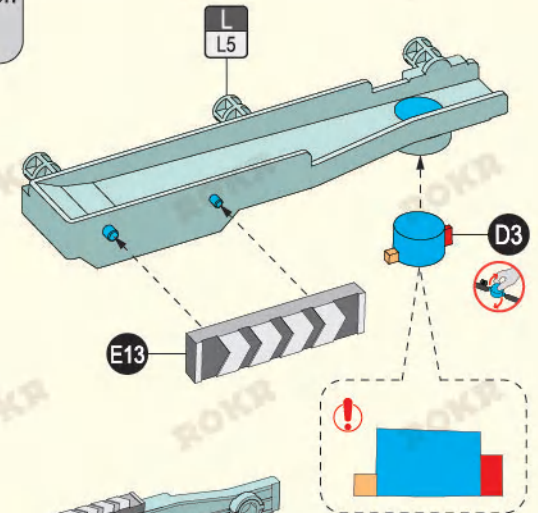
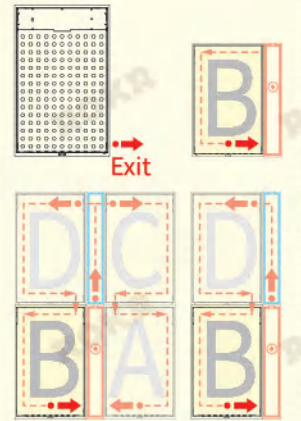

Advanced Play - Module Extension
(Skip it if not needed.)
(Assembly instruction for C)

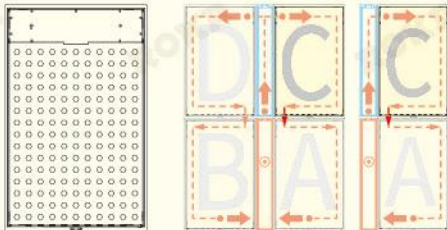

Exit ↓

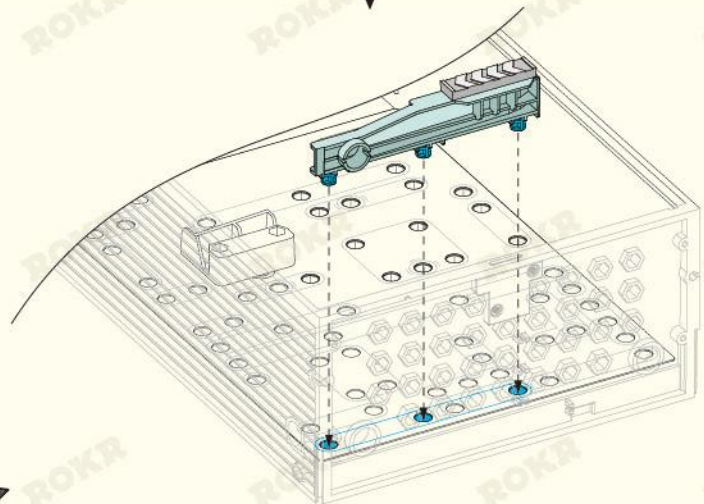
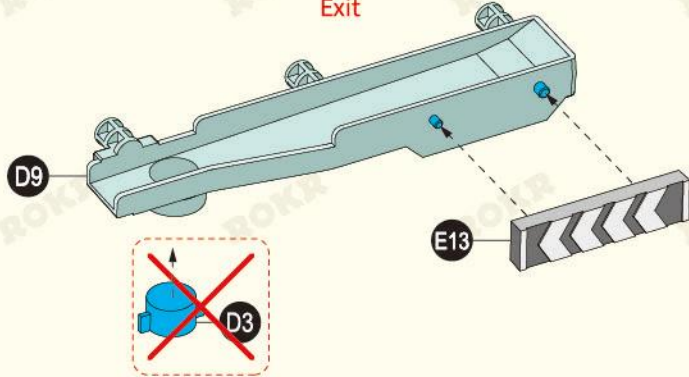

Advanced Play - Module Extension
(Skip it if not needed.)
(Assembly instruction for D)



Exit ↓

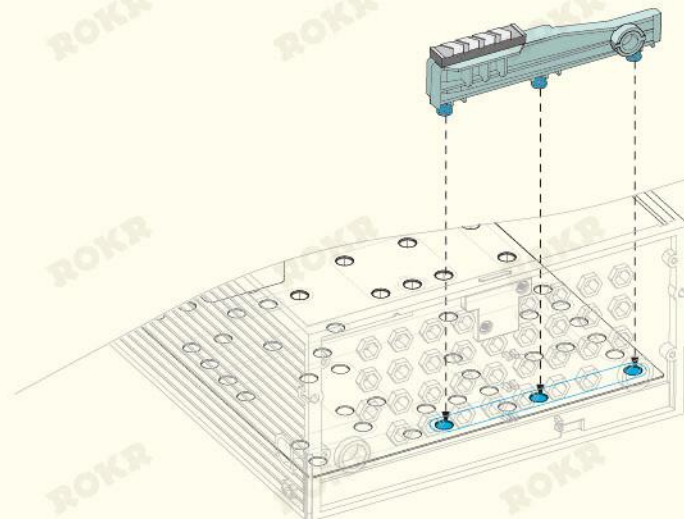
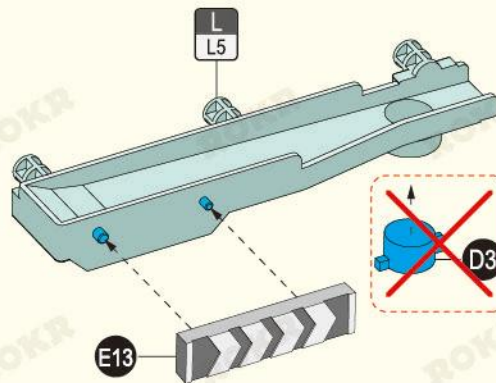
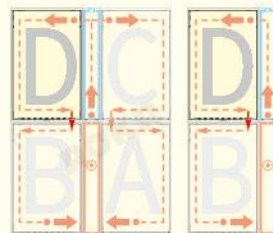

2

<3>

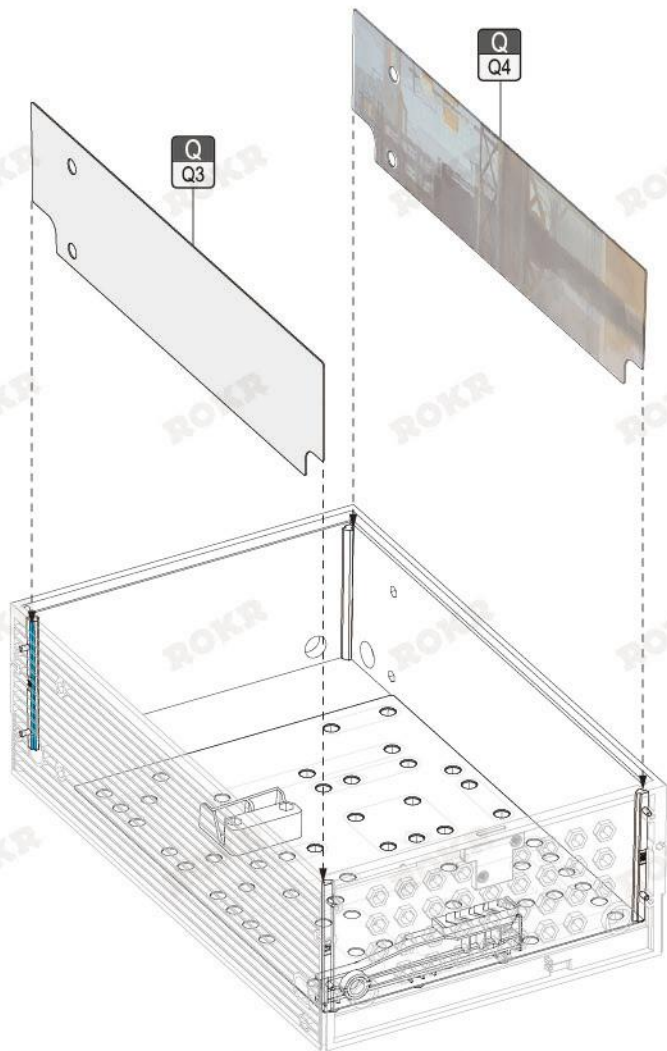

2

<4>

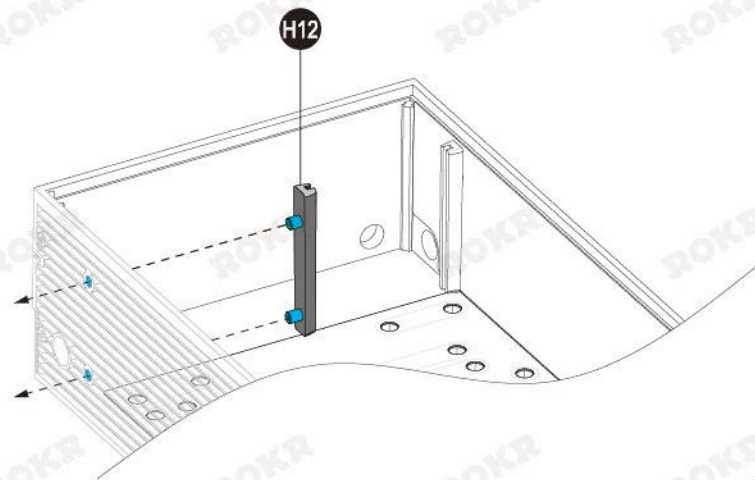
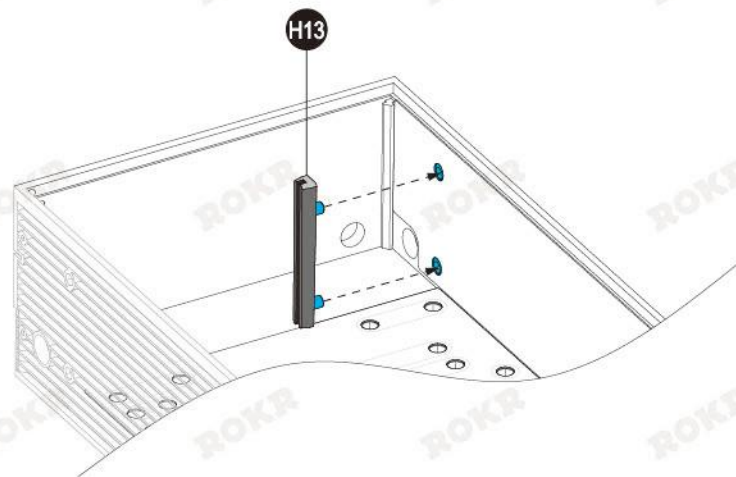

3

Completion

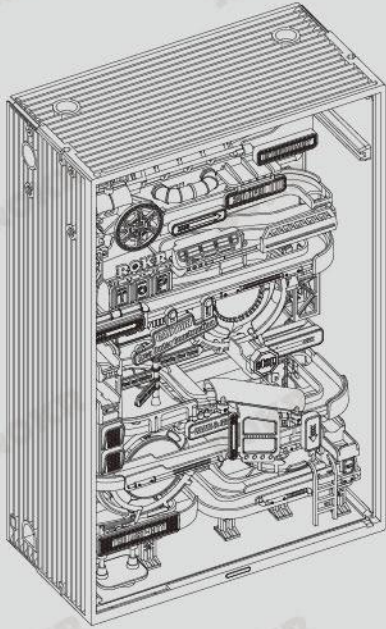

3

<1>

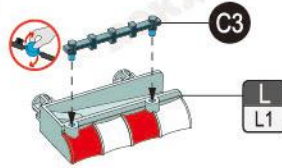

! Cutting points must be cut again; otherwise, it may easily cause ball blocking.

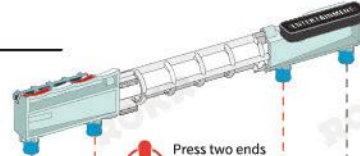
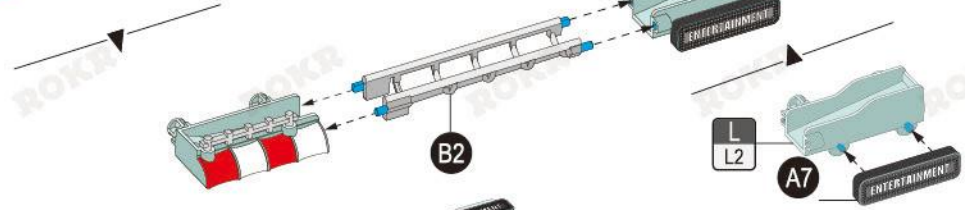

! Press two ends at the same time.

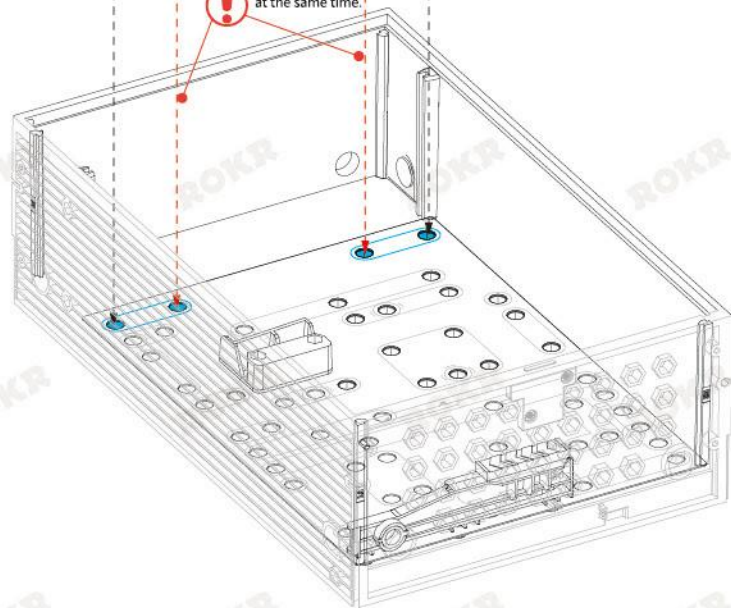

3

<2>

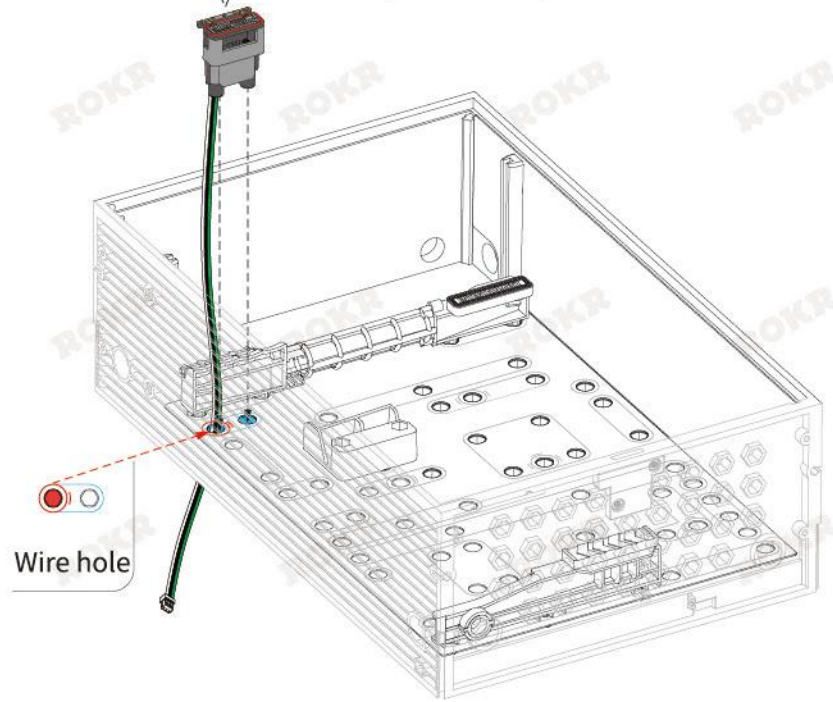
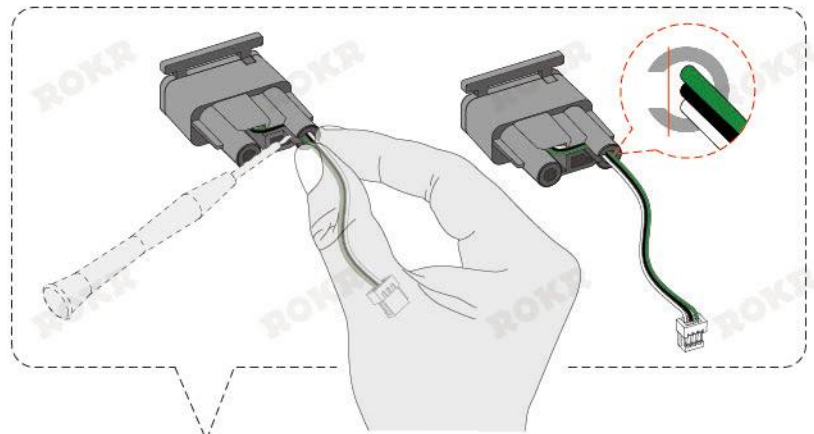
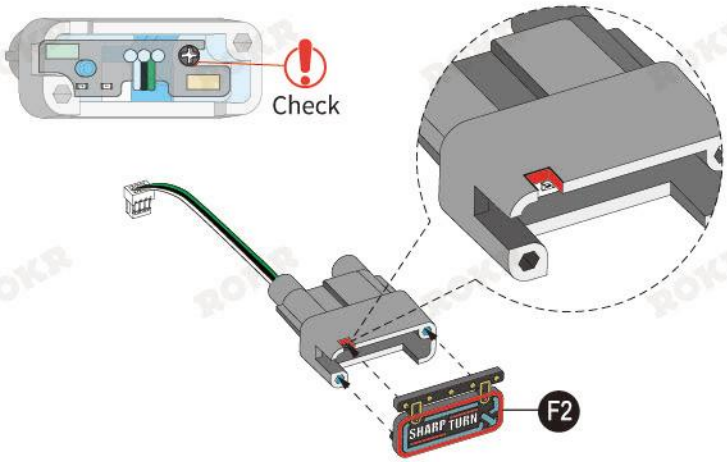
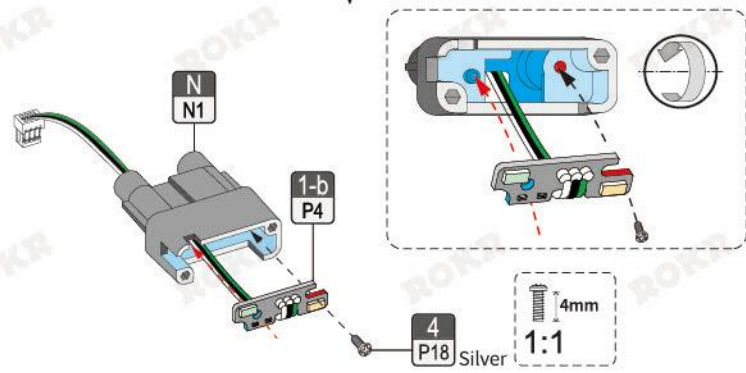
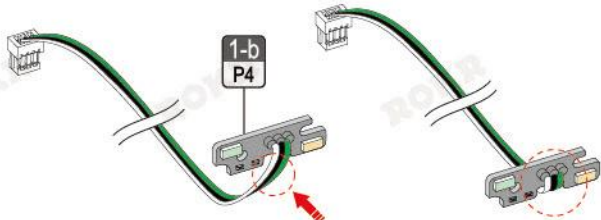

3

<3>

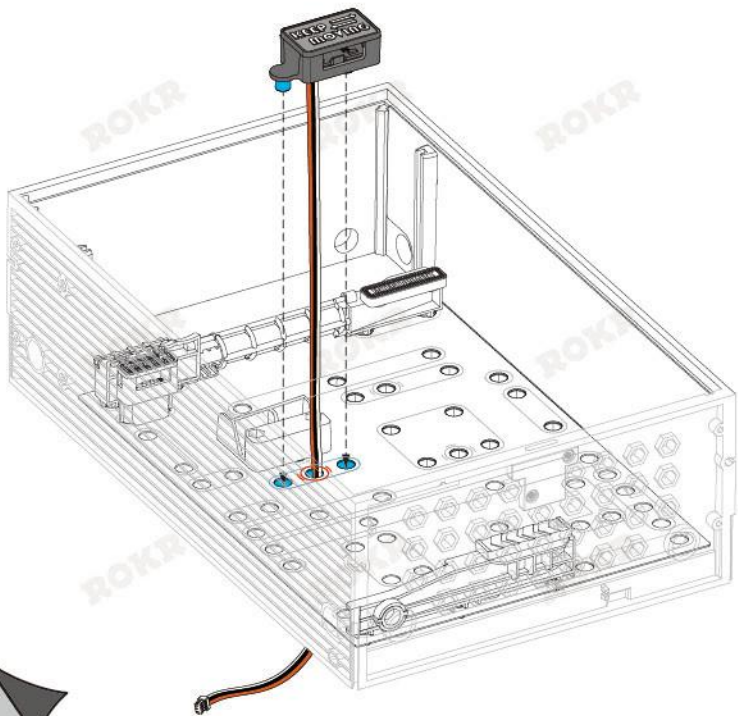
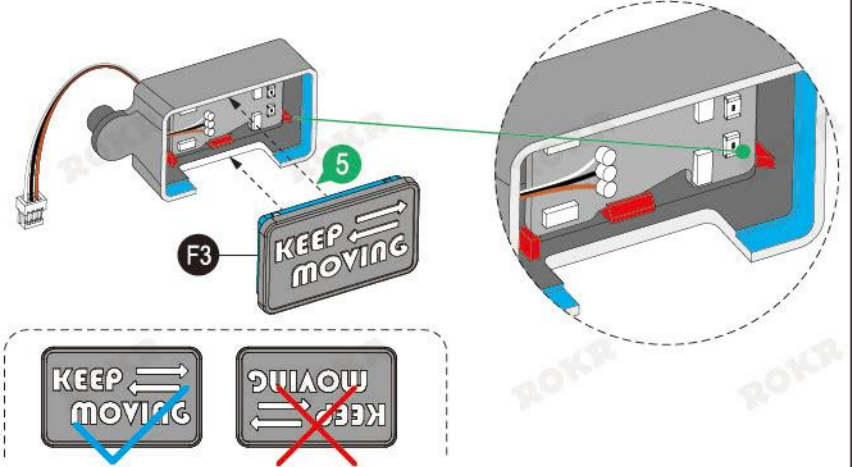
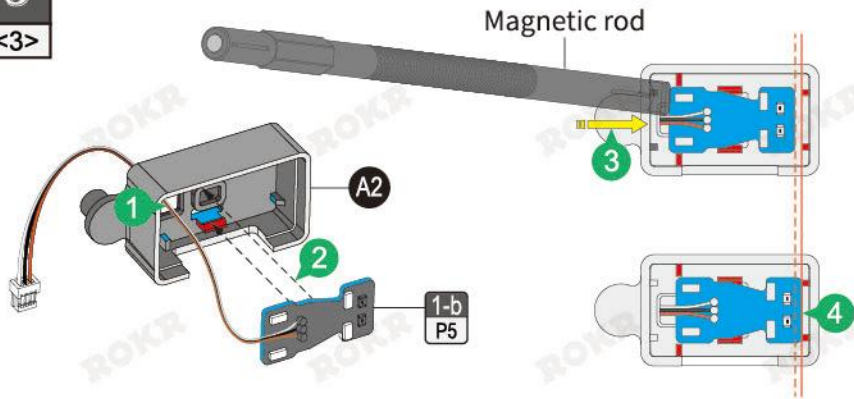

3

<4>

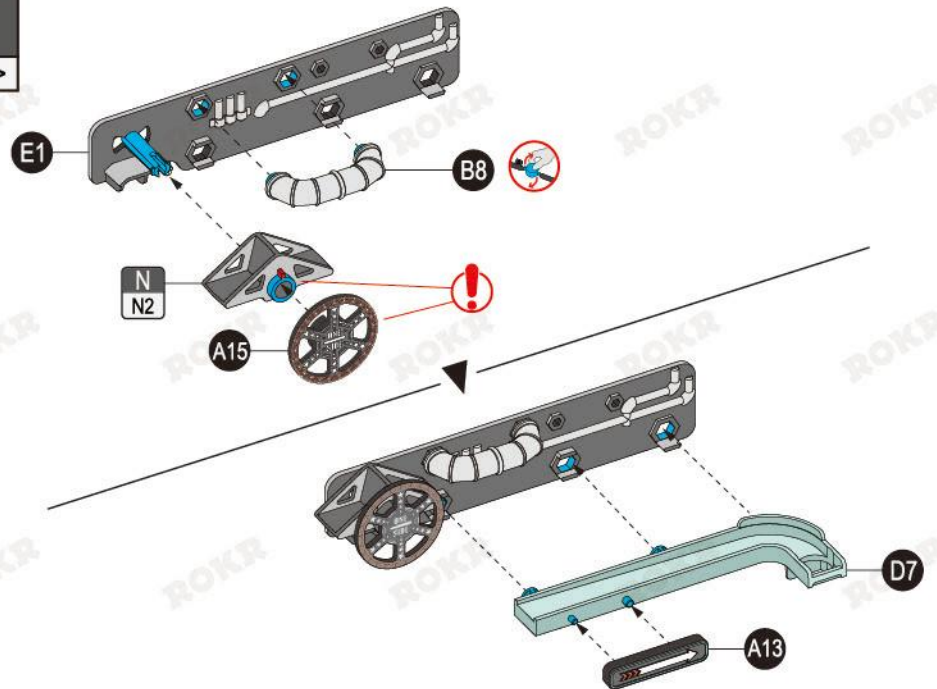

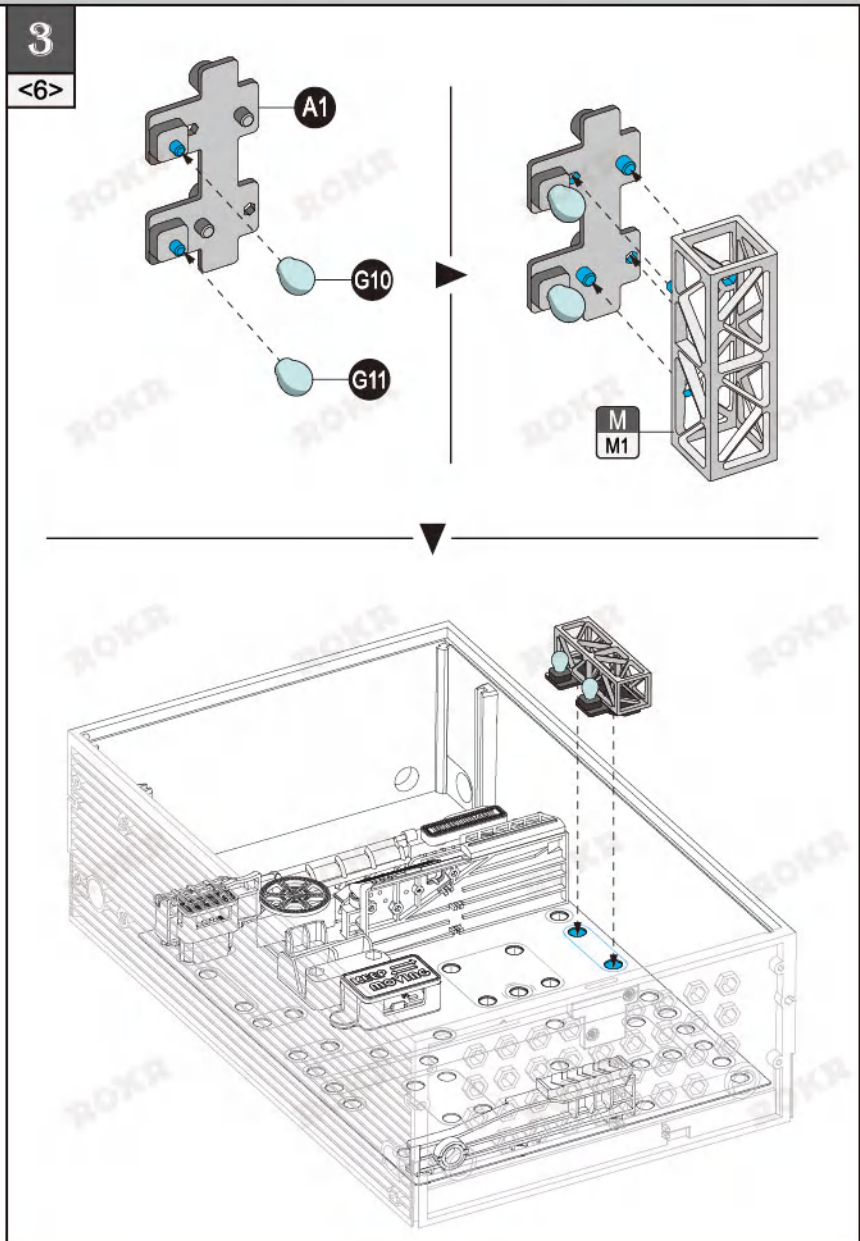
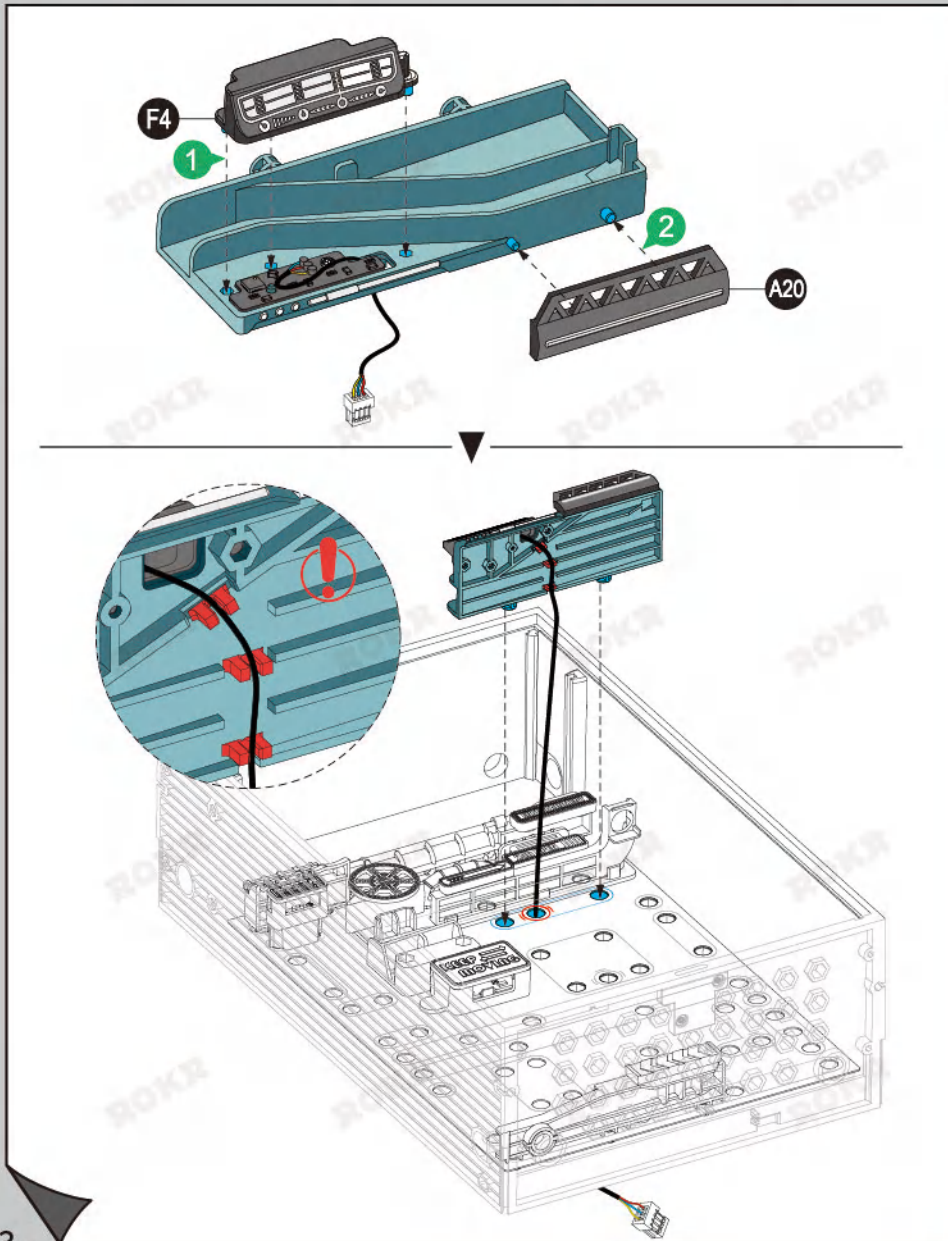

3

<7>

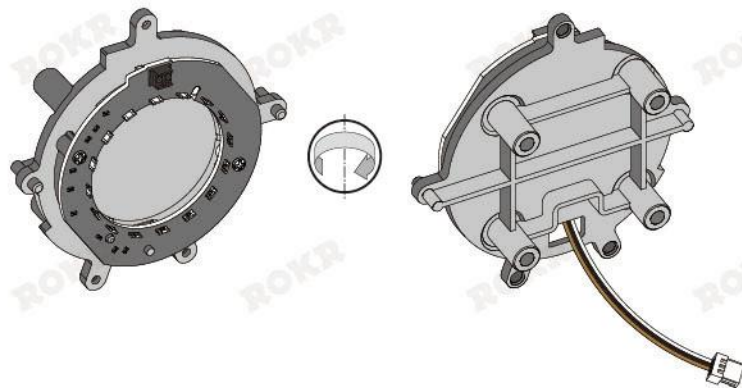
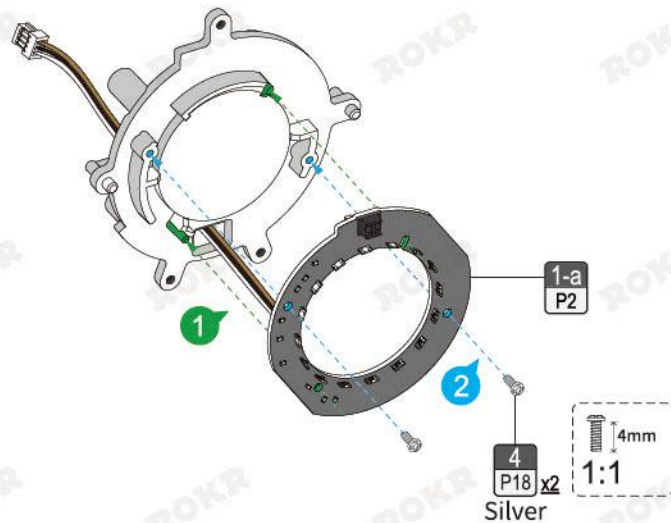
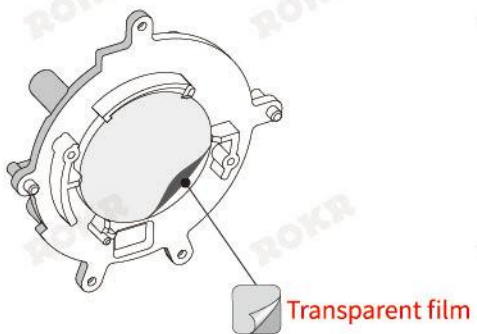
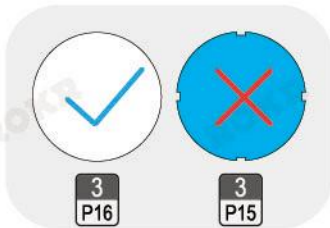

3

<8>

3
P15

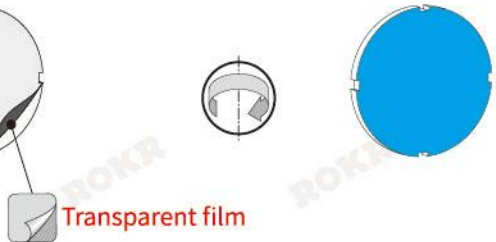

Transparent film

M
M2

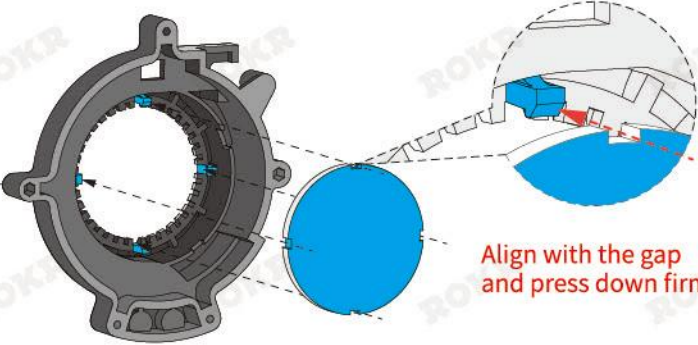

Align with the gap
and press down firmly.

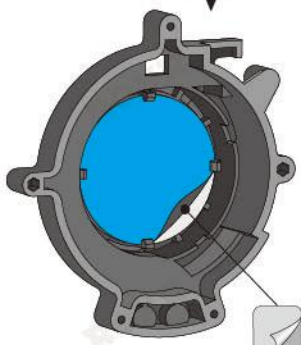

Blue transparent film

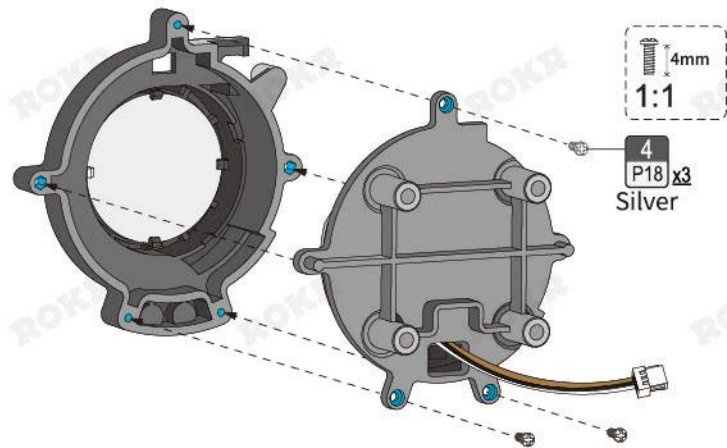

4mm
1:1

4
P18 x3
Silver

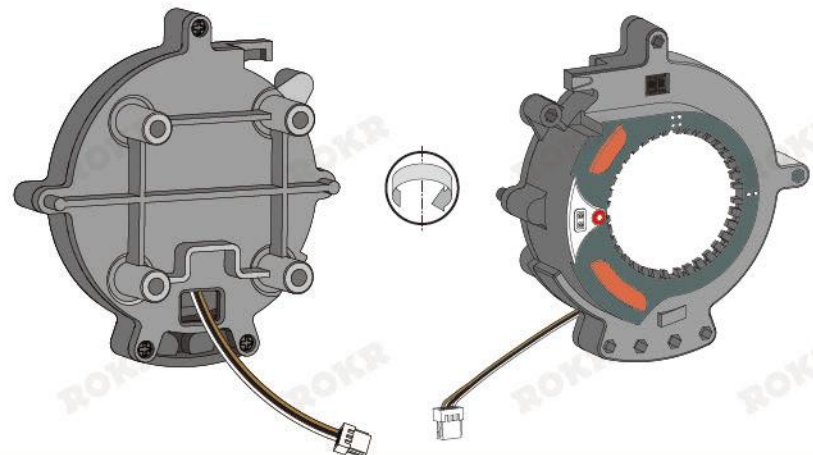

Align with the gap
and press down firmly.

3

<9>

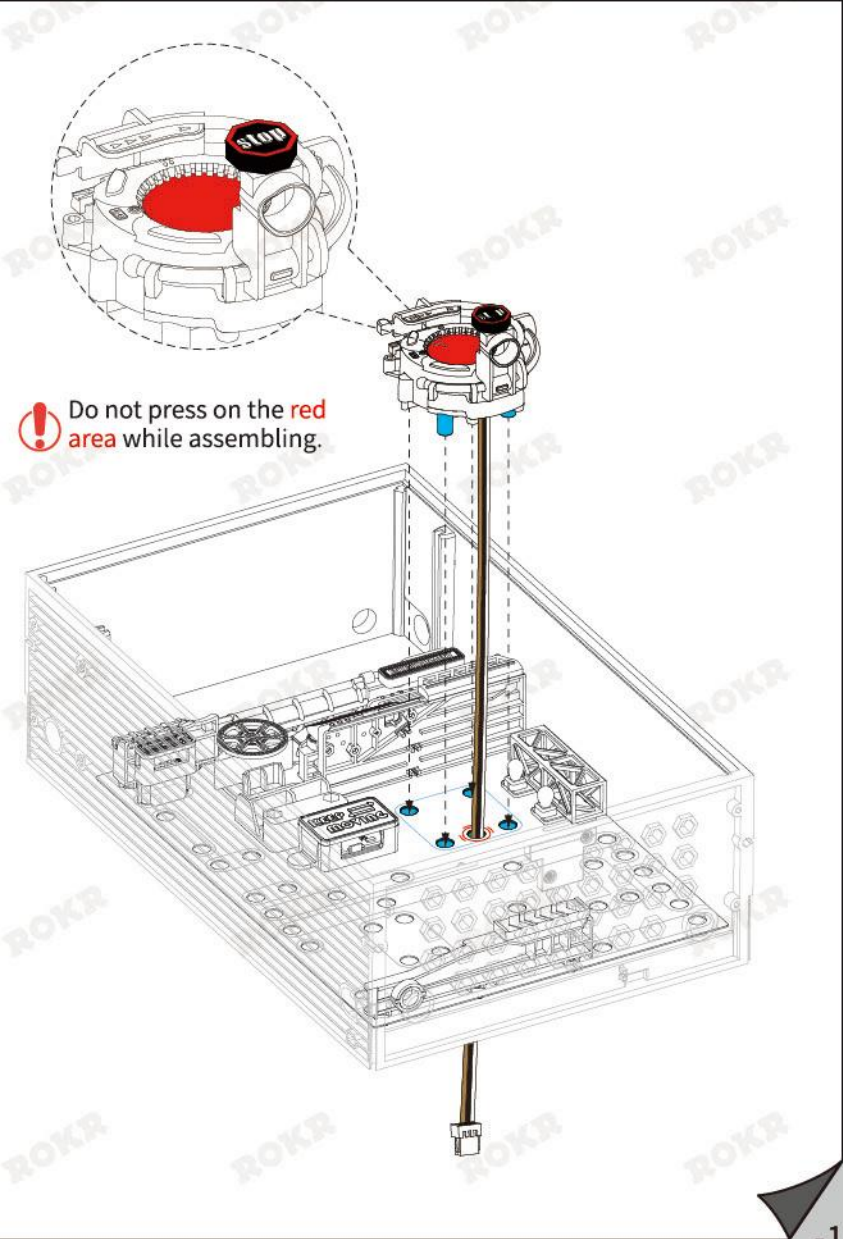
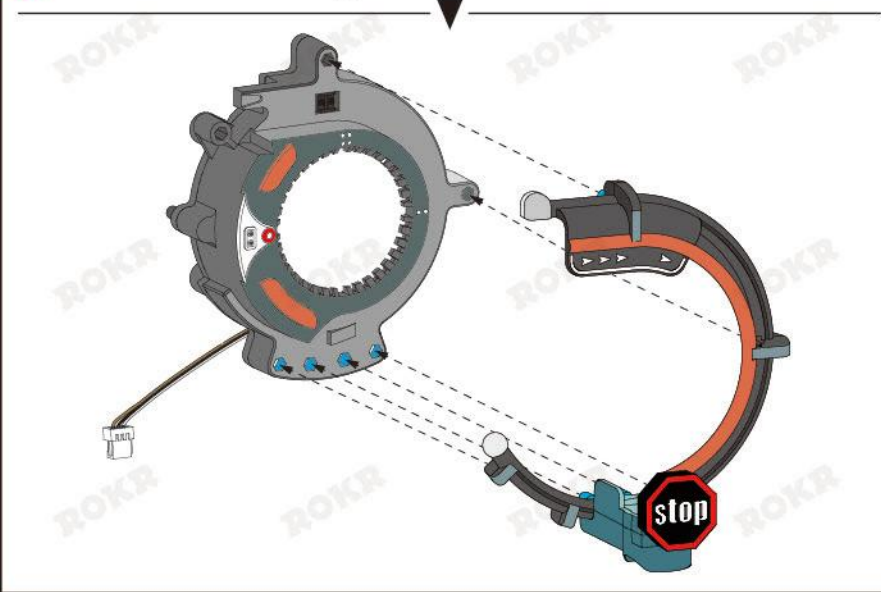
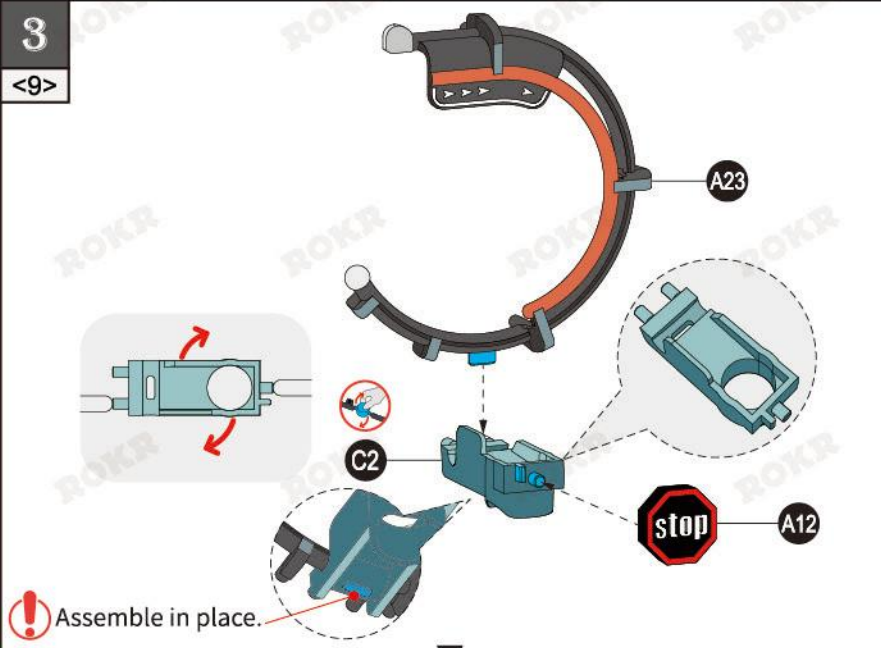

3

<10>

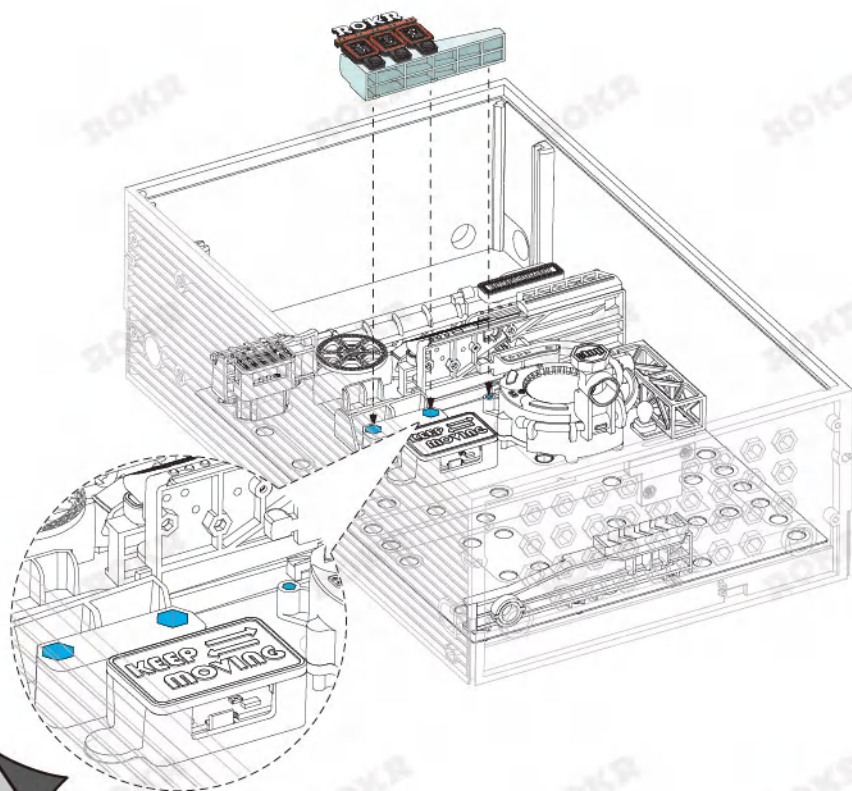
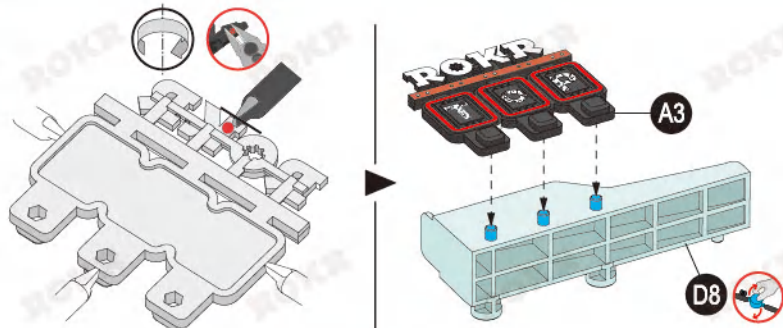

3

<11>

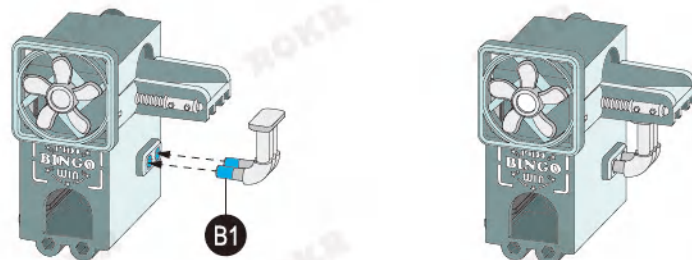
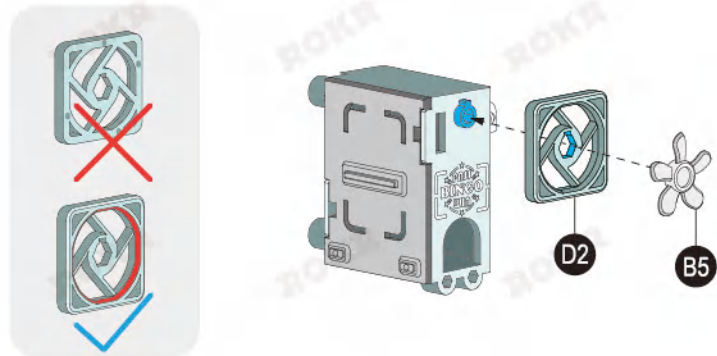
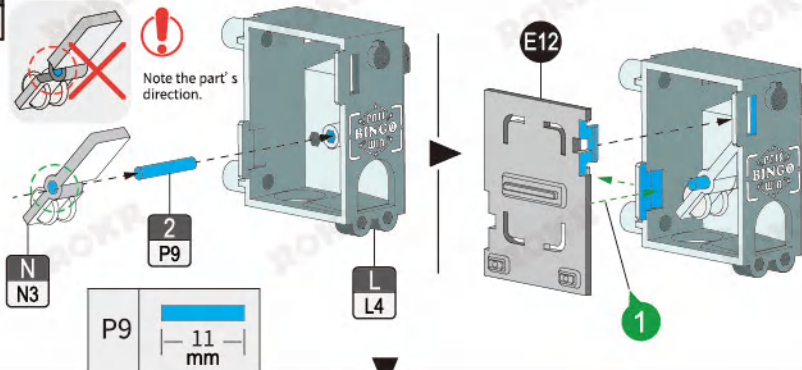

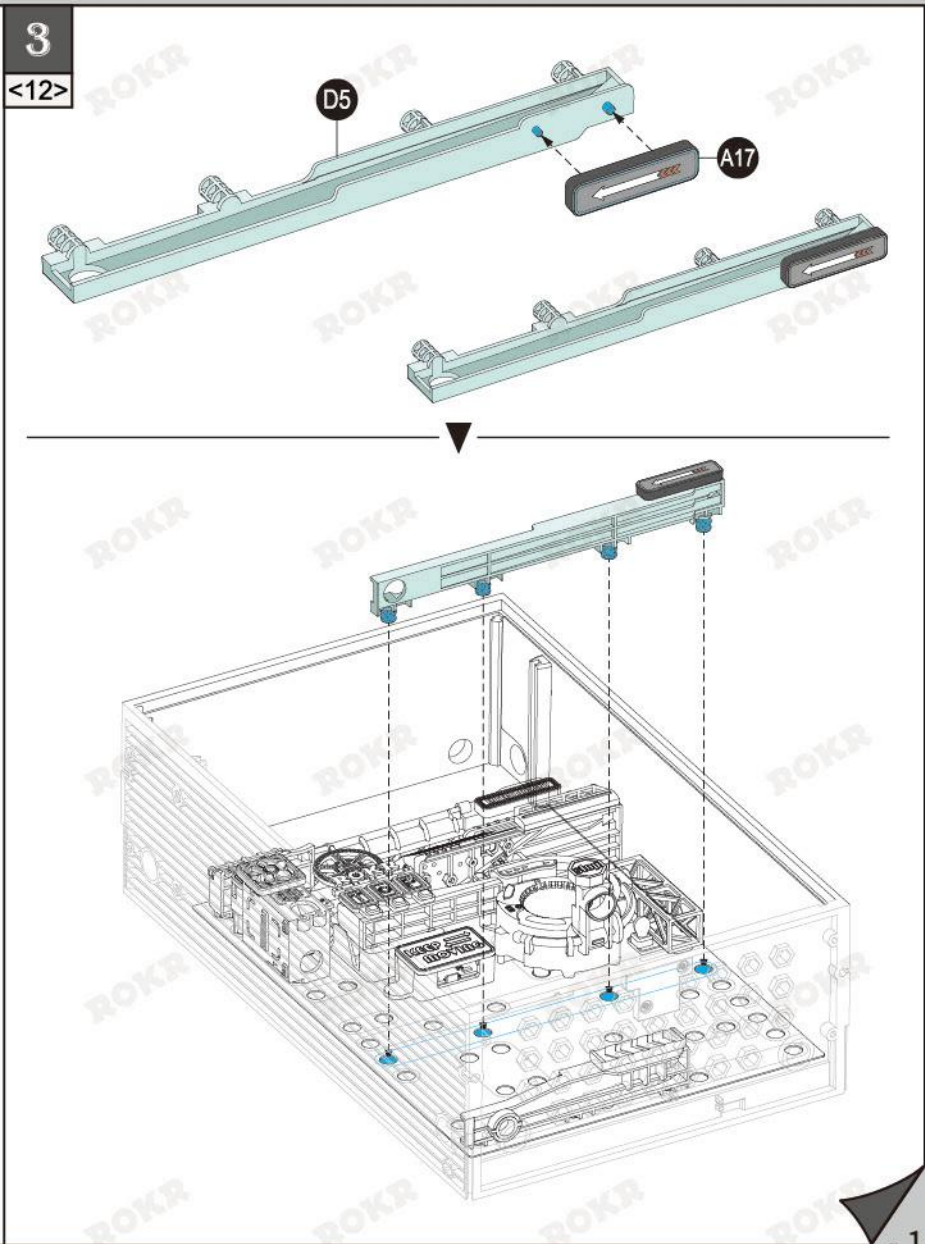
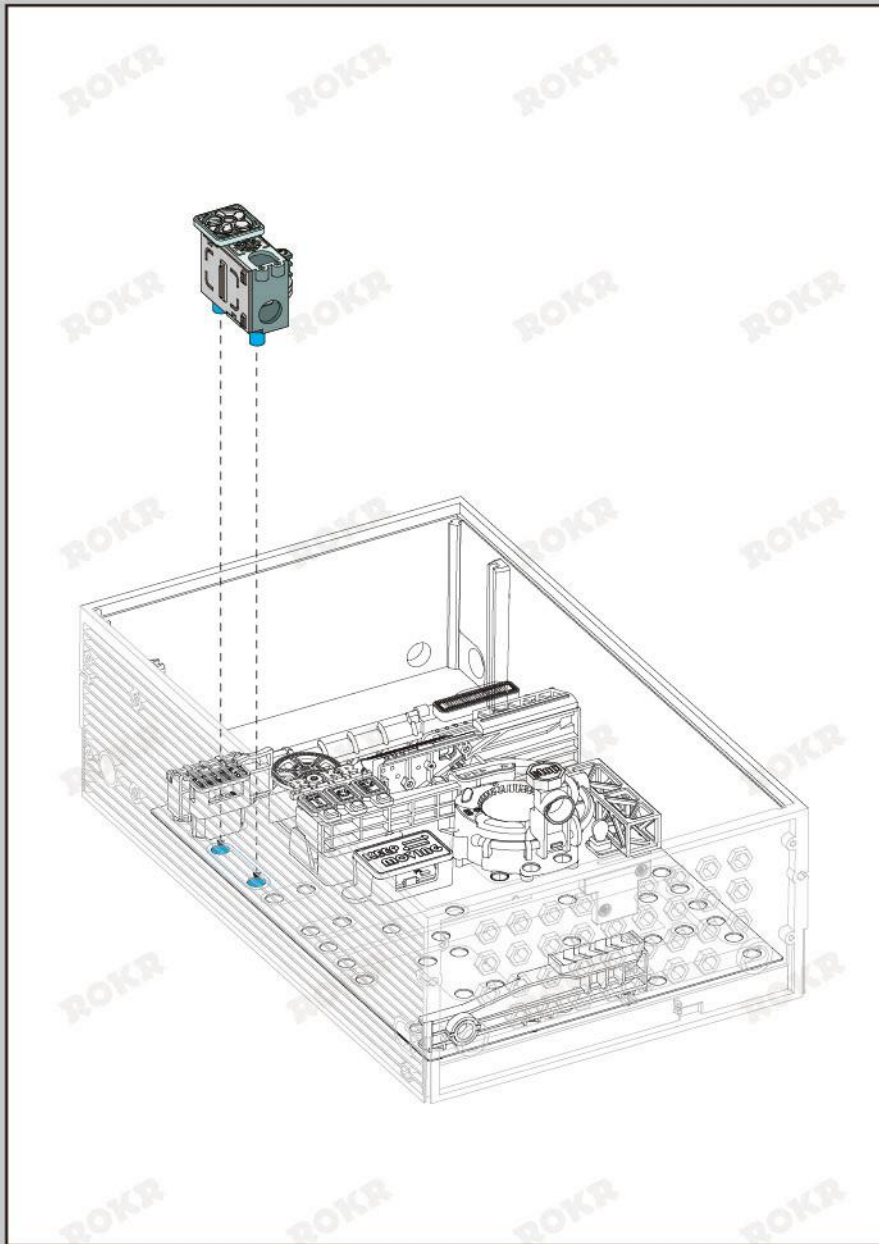

3

<13>

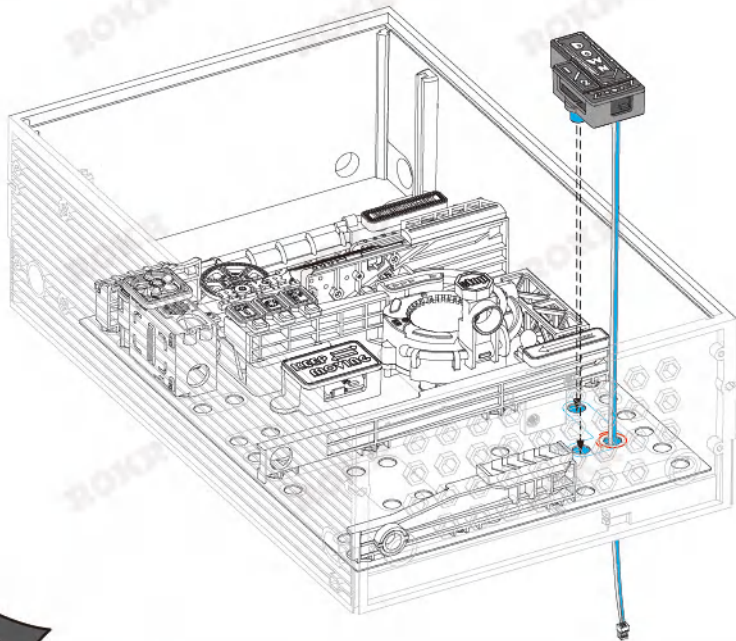
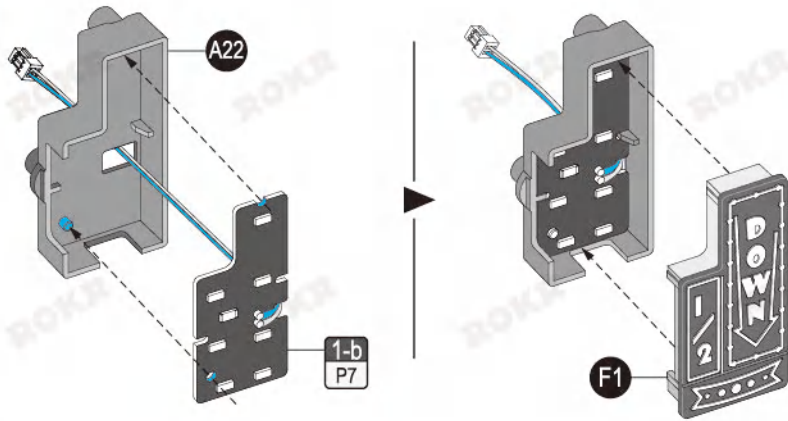

3

<14>

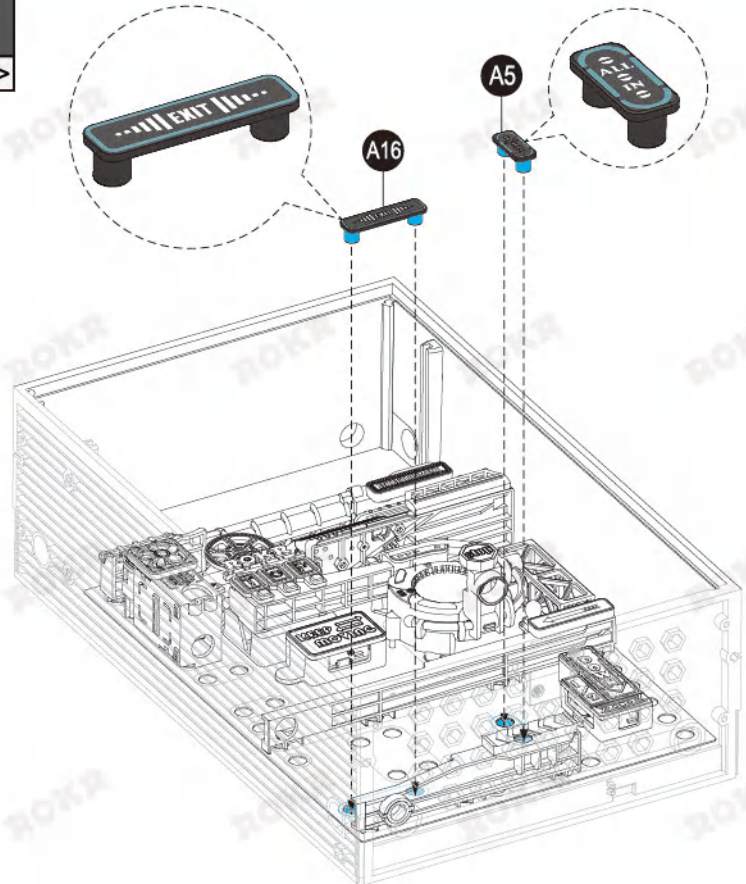

Hole position illustration

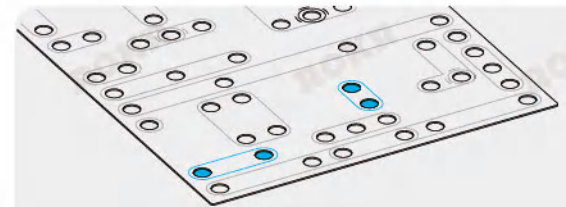

3

<15>

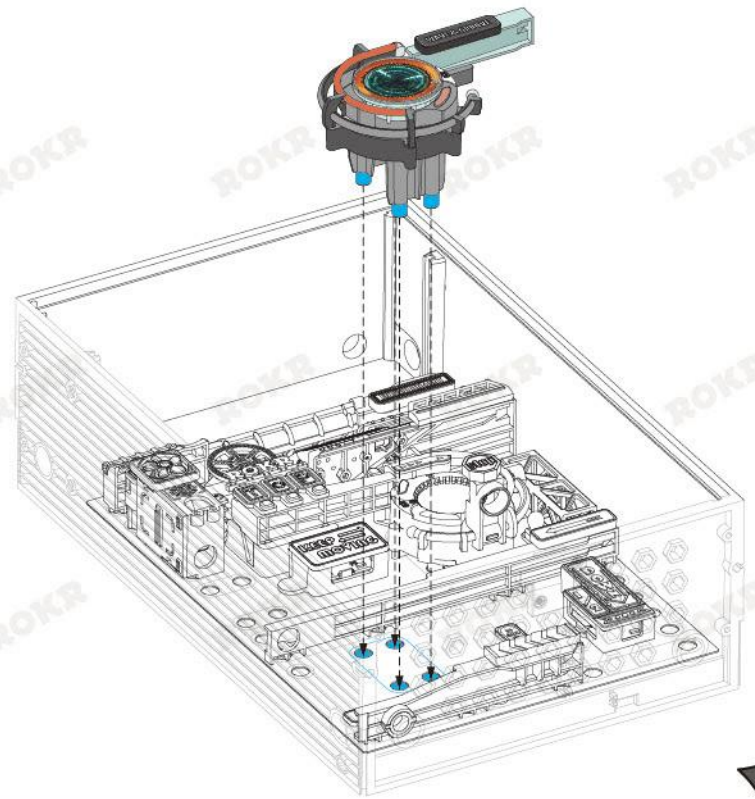
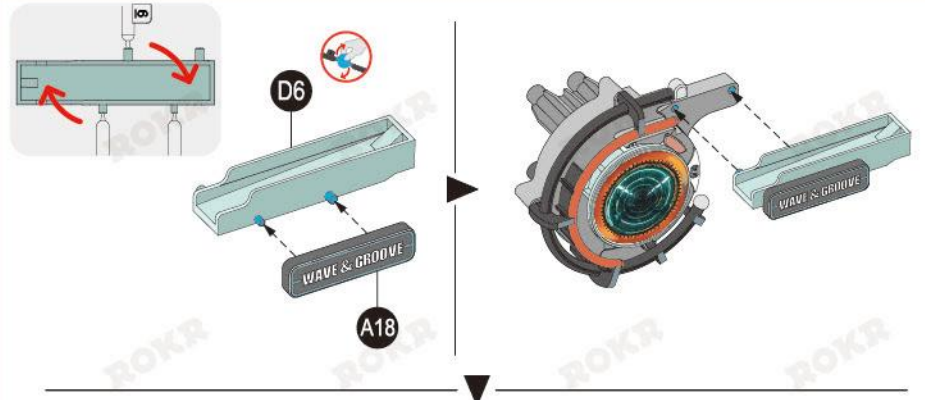
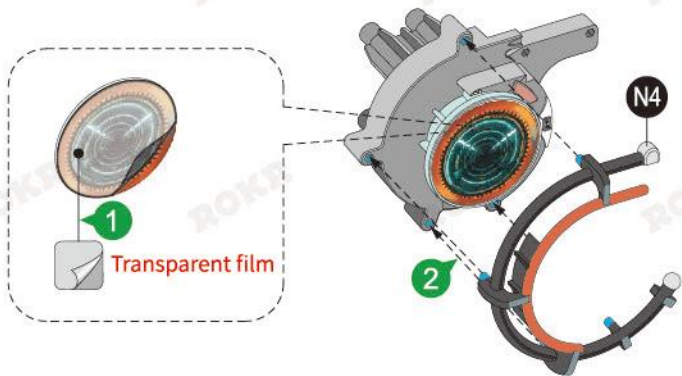
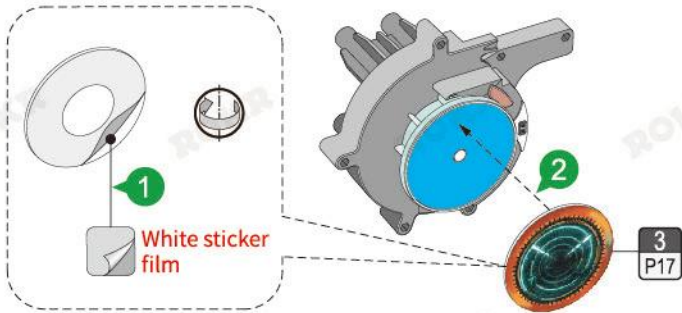
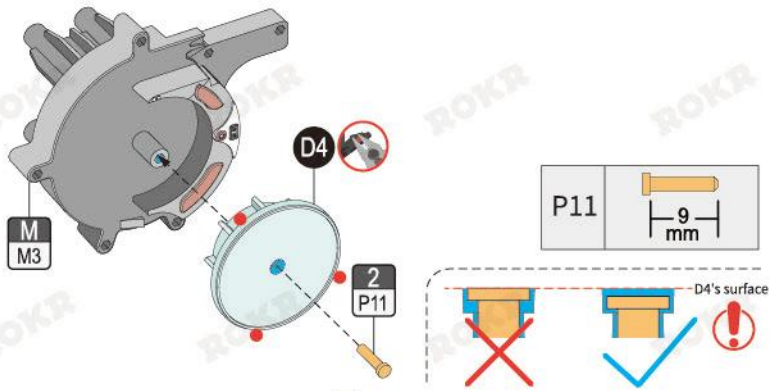

3

<16>

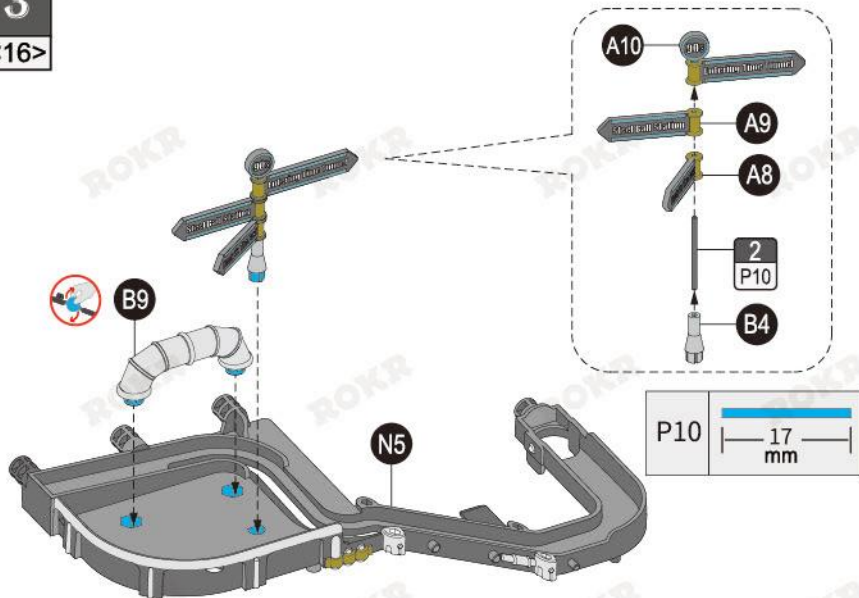

P10 17 mm

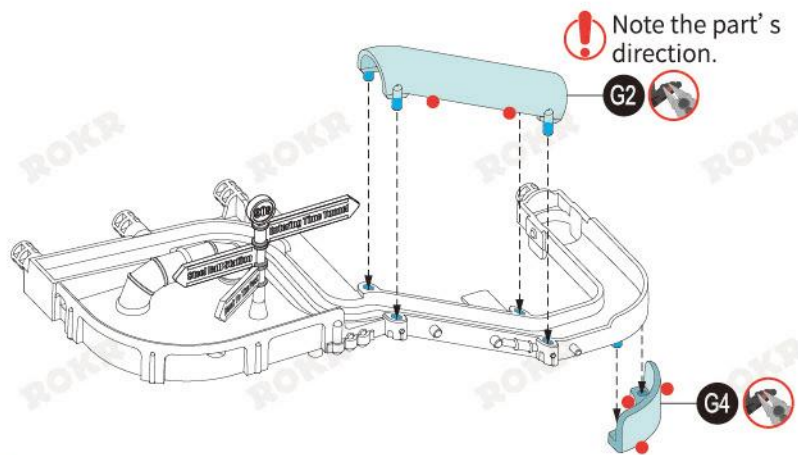

! Note the part's direction.

G2

G4

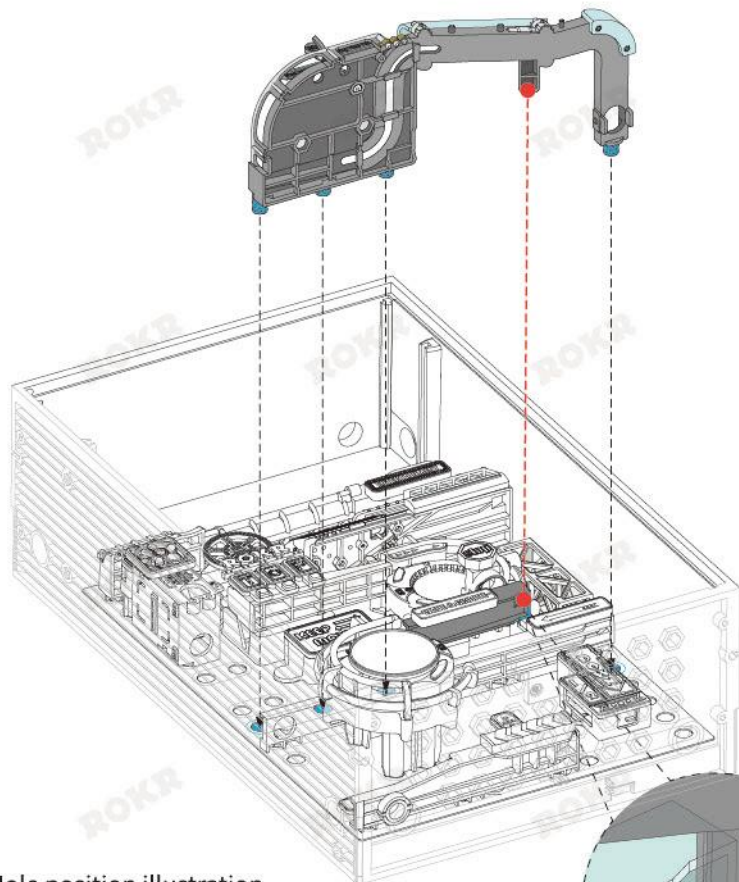

Hole position illustration

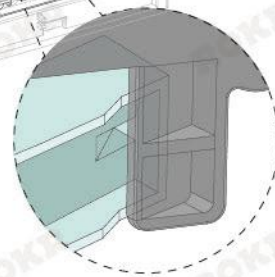
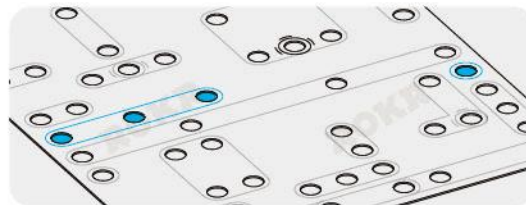

3

<17>

! Removing sequence

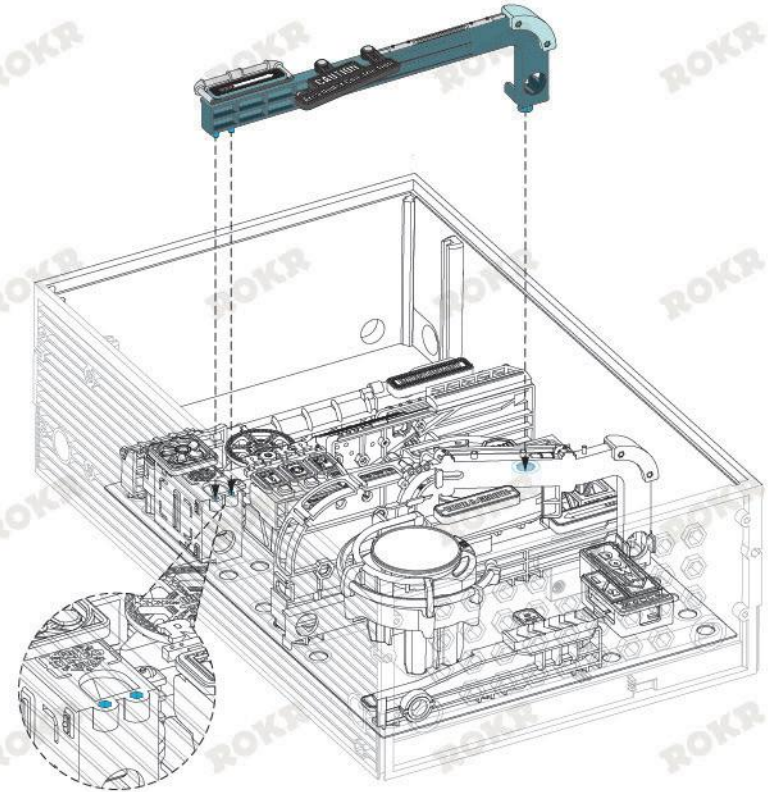
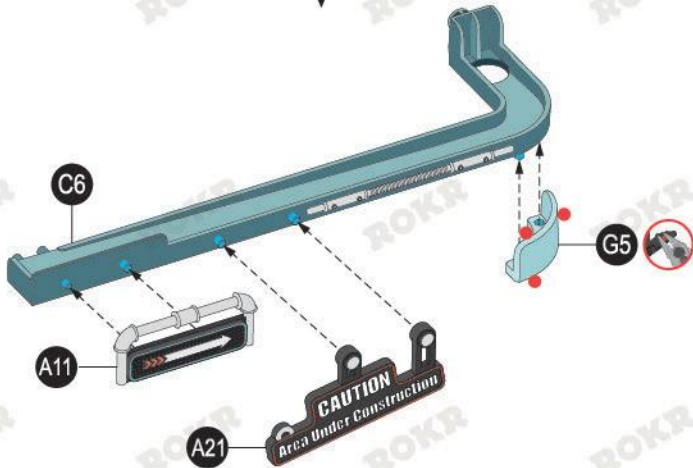
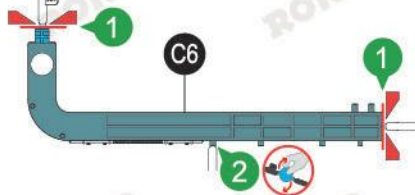
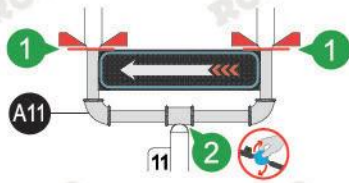

3

<18>

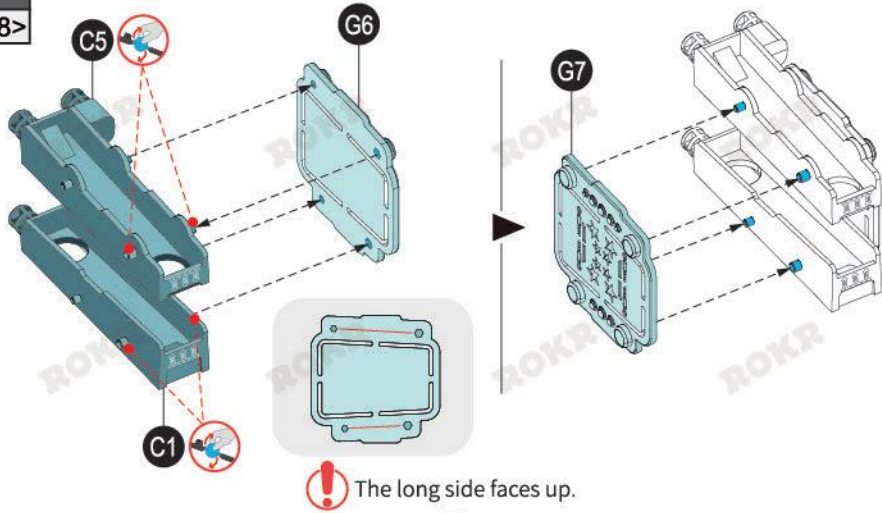

! The long side faces up.

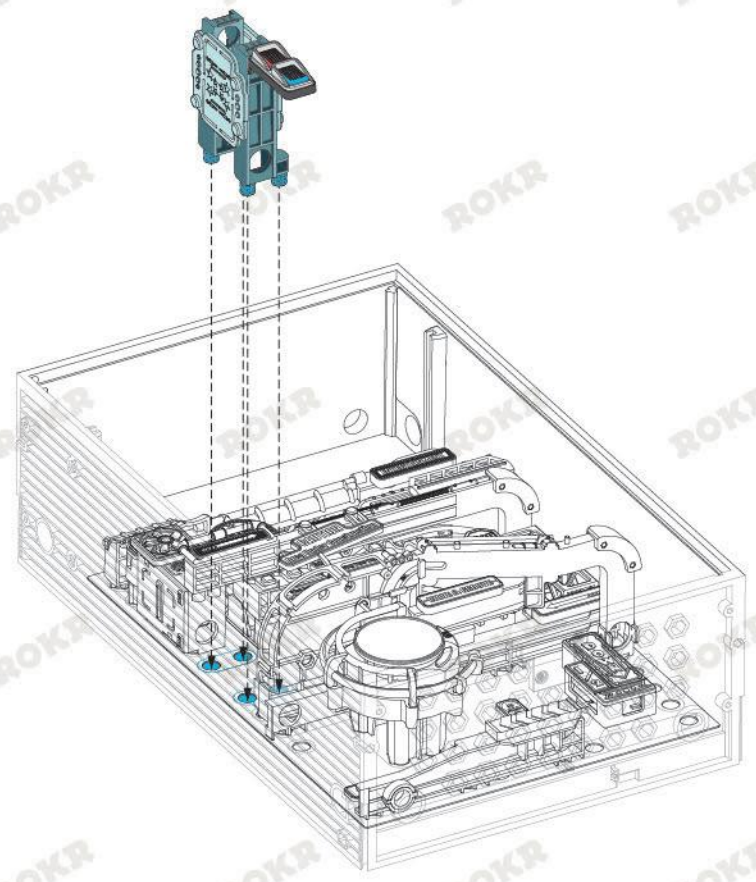
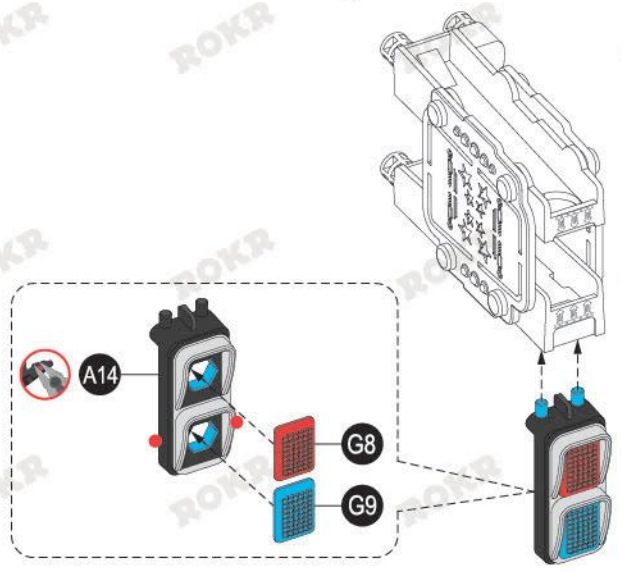

3

<19>

⚠ Note the part's direction.

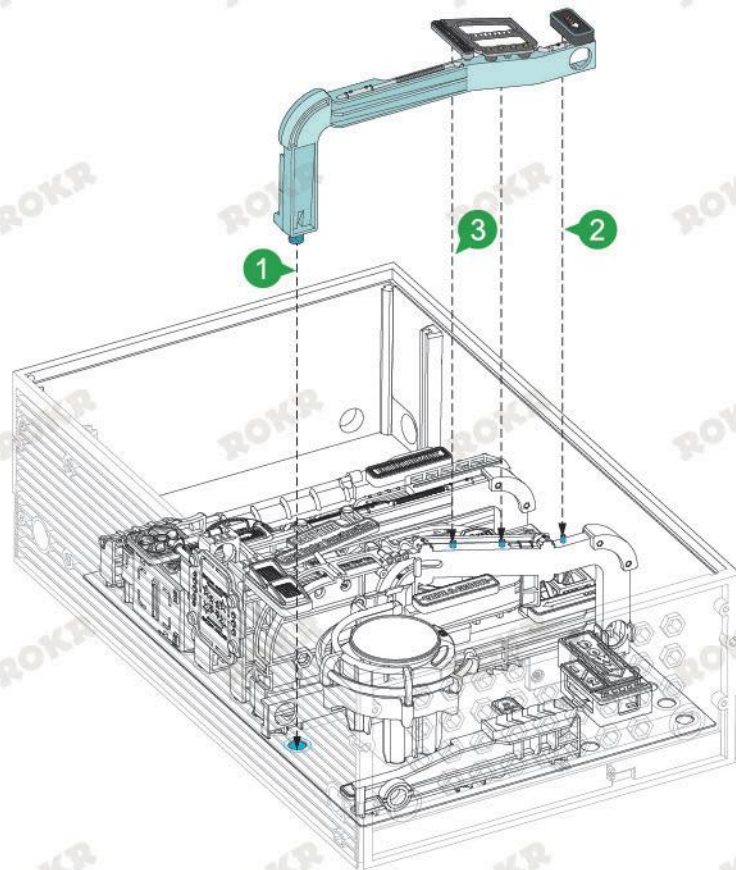
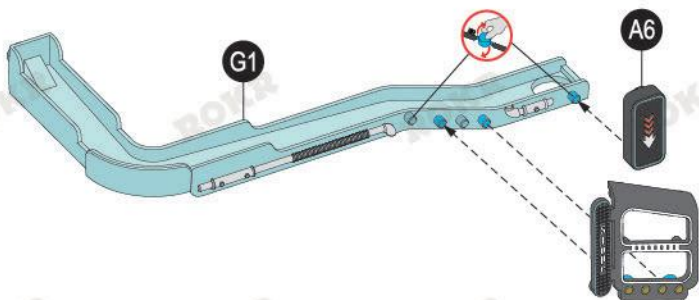
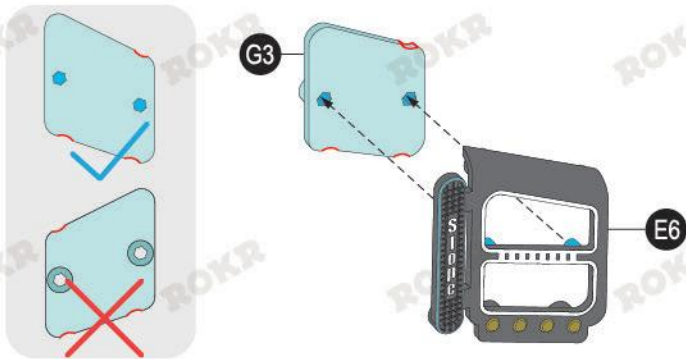

3

<20>

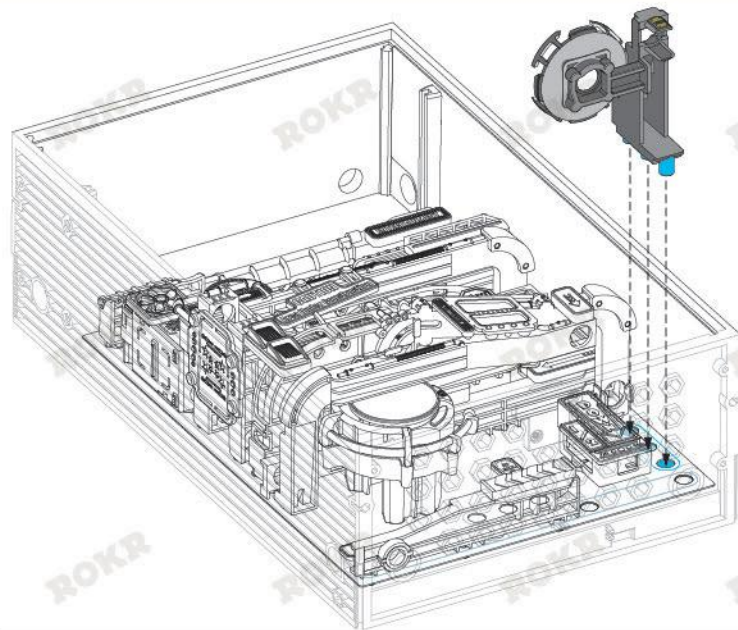
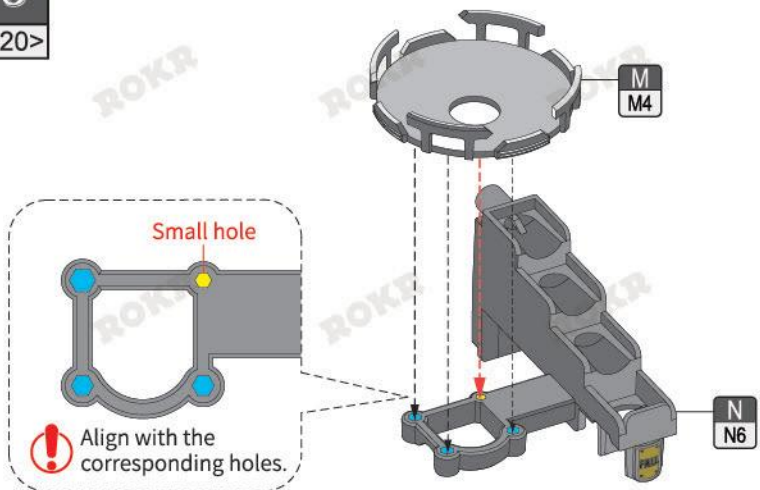

3

<21>

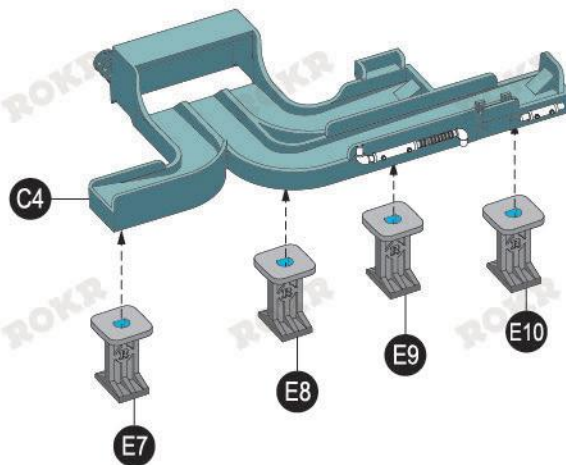

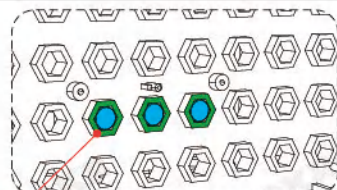
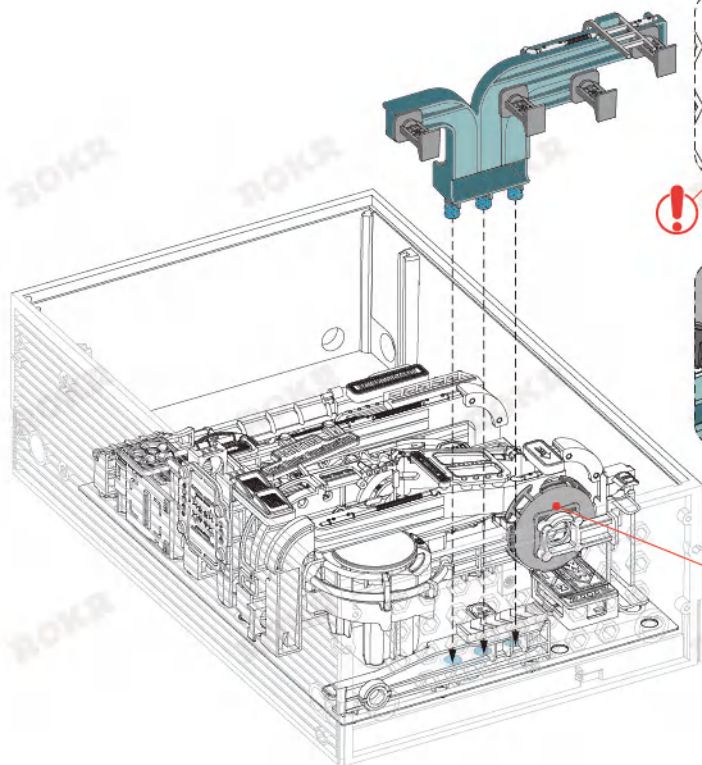
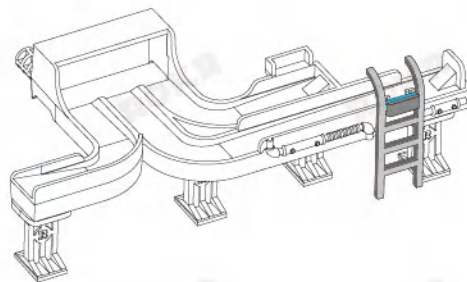
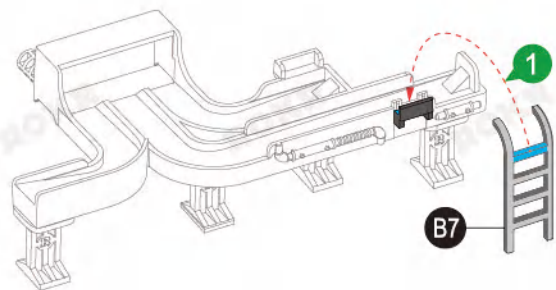

! Do not protrude the hole surface.

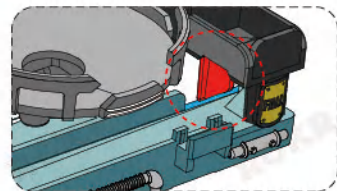

! Slightly push this part to assemble easily.

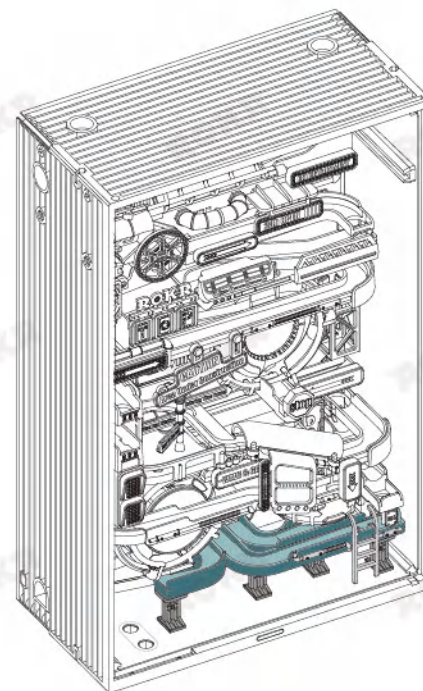

3

<22>

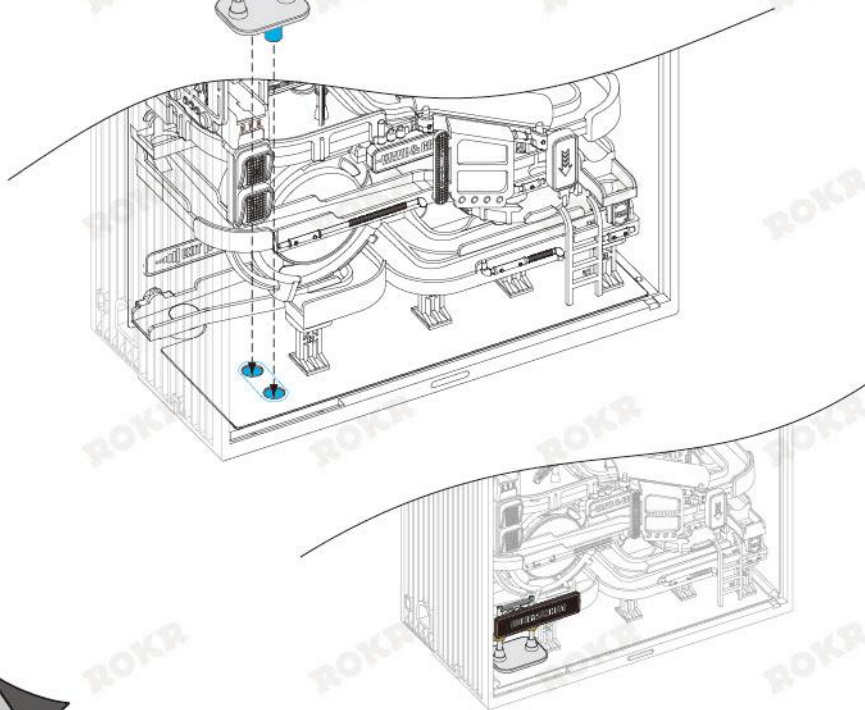
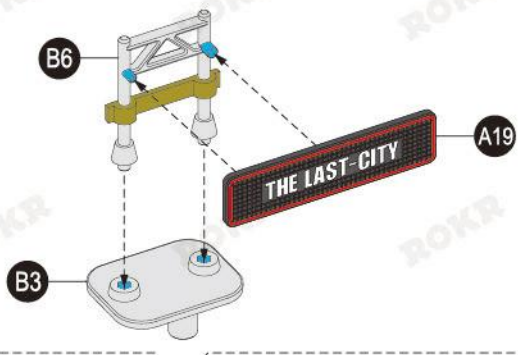

4

Basic Play
(Assembly instruction for A/C)

<1>

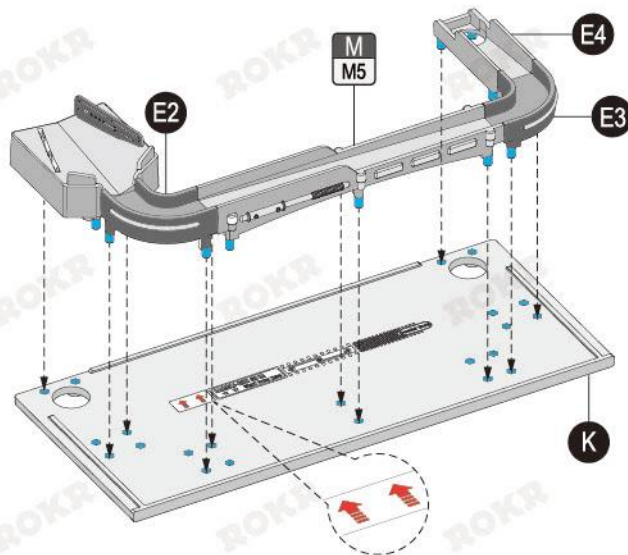
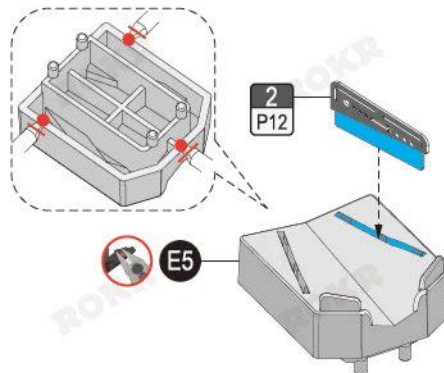
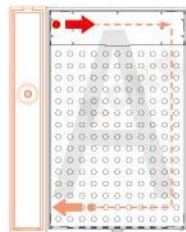

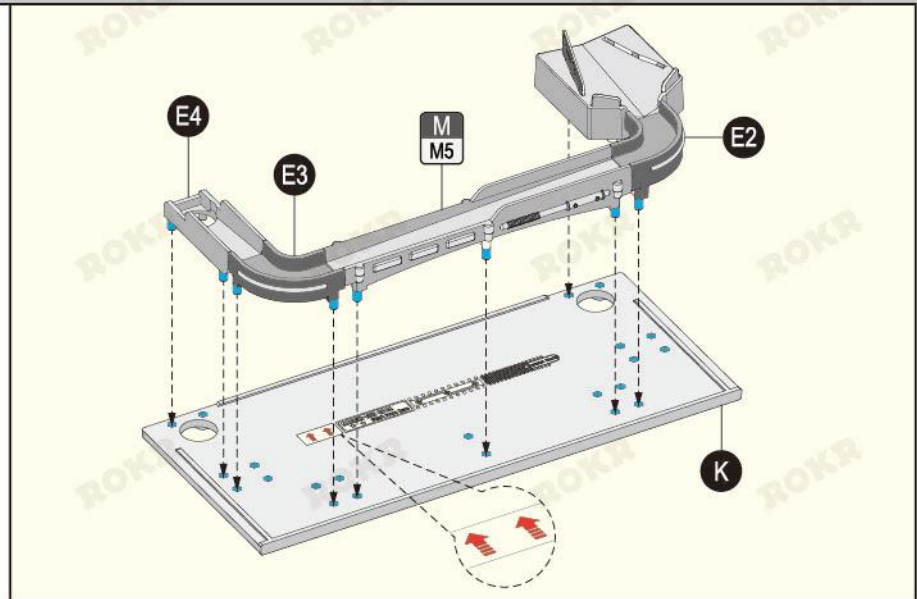
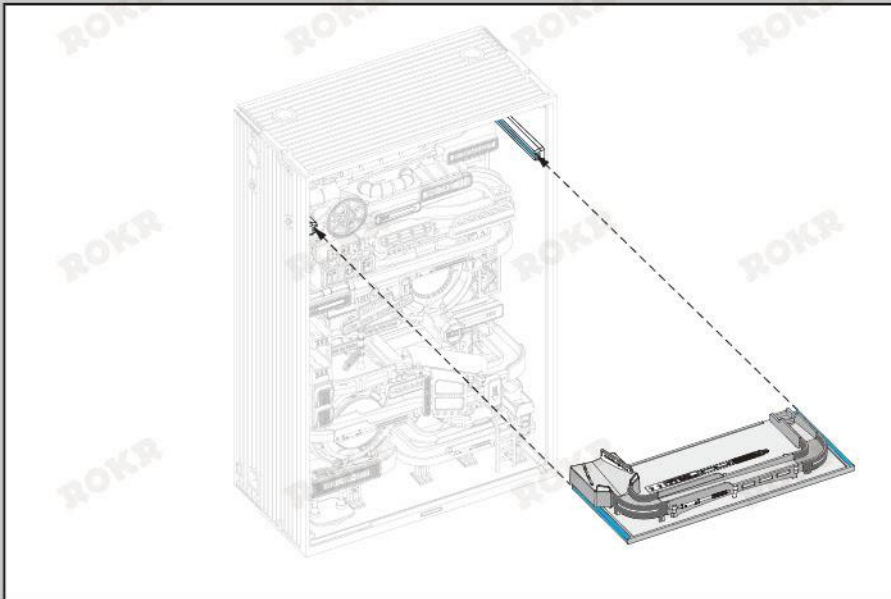

Advanced Play - Module Extension
 (Skip it if not needed.)
 (Assembly instruction for B/D)

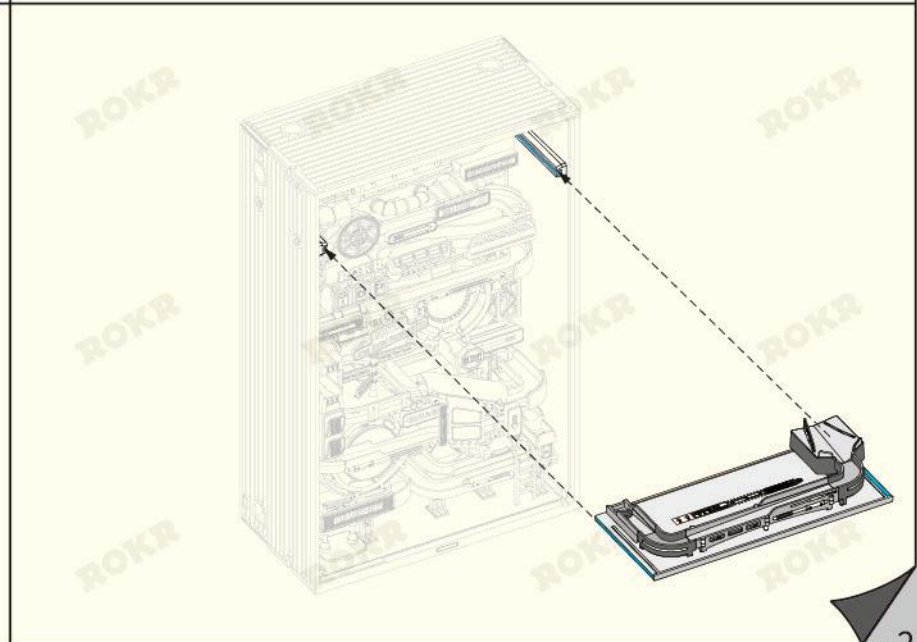
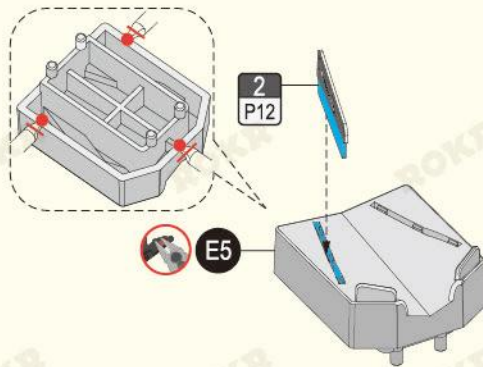
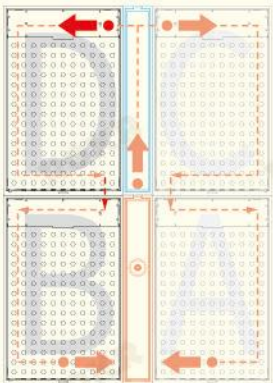

5 Test marbles' running

- ! Put **12 marbles** in sequence into the entrance at intervals of **1-2 seconds** and observe if they can come out from the exit.
(Put too many marbles quickly may get stuck.)

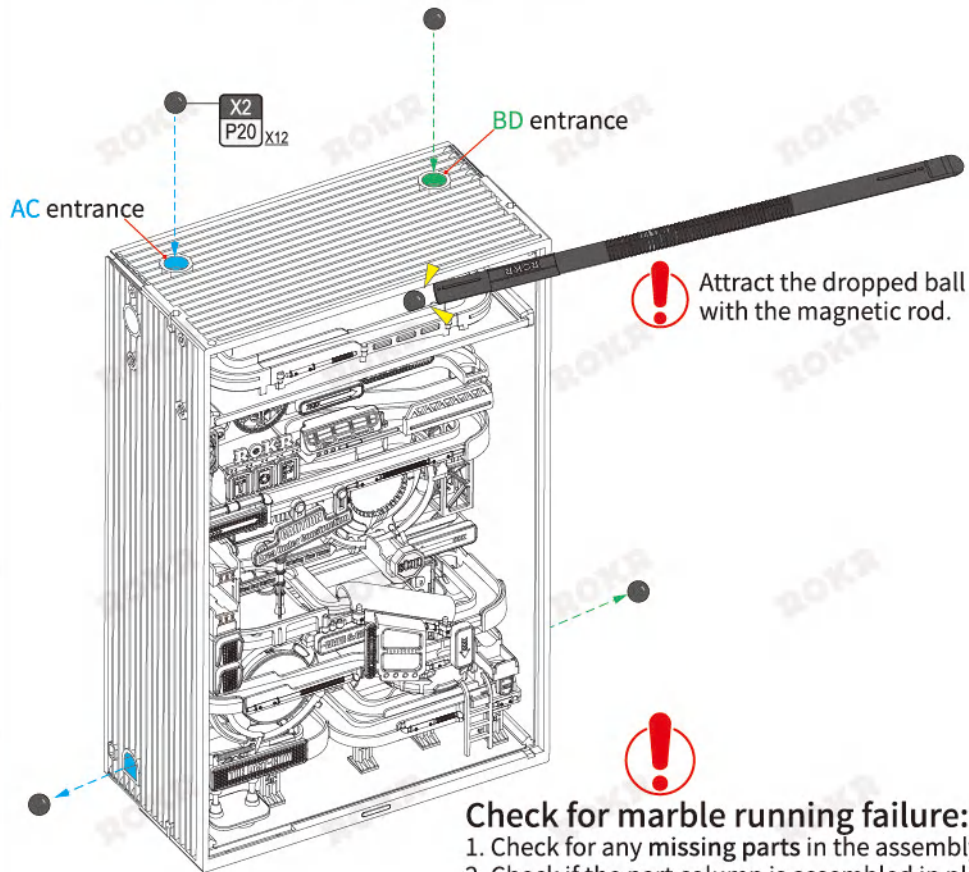

! Attract the dropped ball with the magnetic rod.

- ! **Check for marble running failure:**
1. Check for any missing parts in the assembly.
 2. Check if the part column is assembled in place. It should be flushed with the hole surface.
 3. All tracks should be connected in place.

6

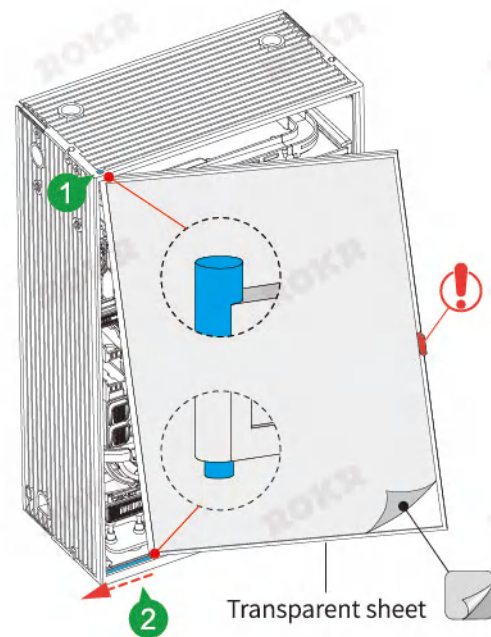

Transparent sheet

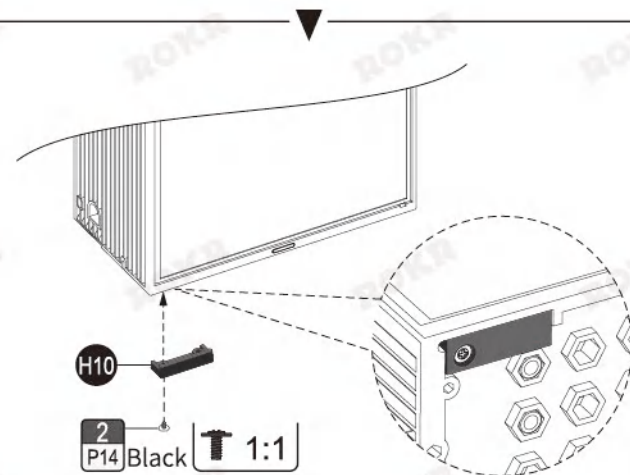

7

<1>

! Note the terminal direction.

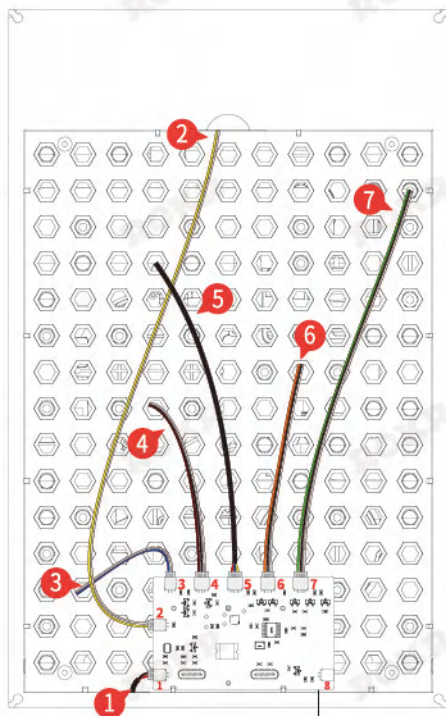
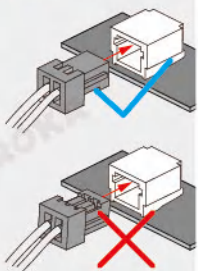

1-a
P1

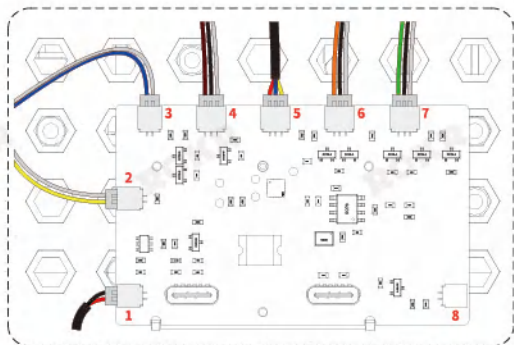

7

<2>

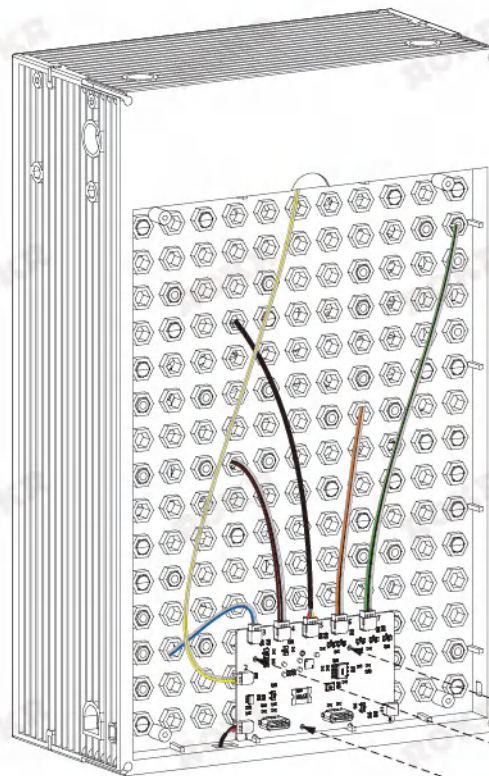

4mm
1:1

4
P18 x3 Silver

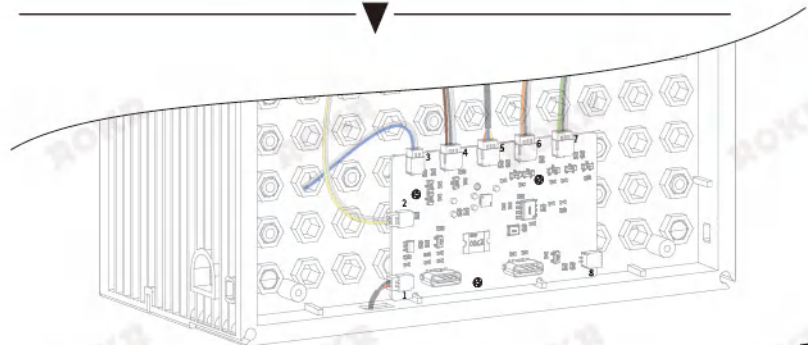

7

<3>

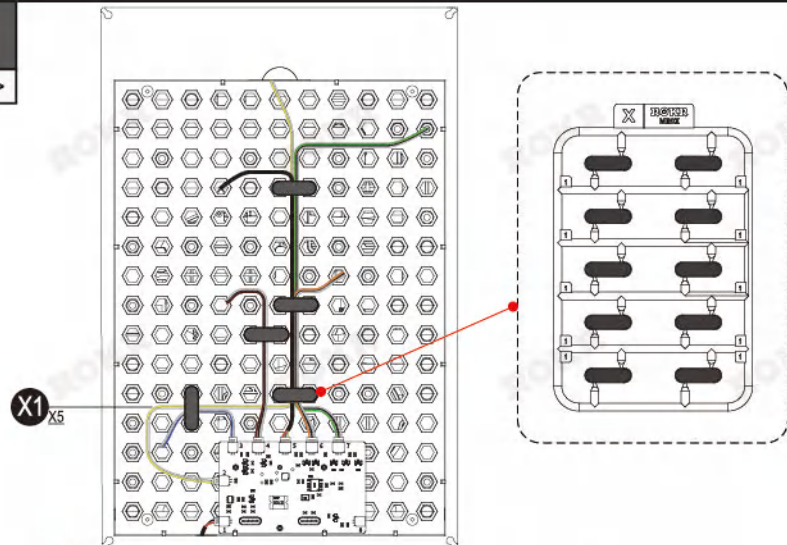

 Secure the wire with the sticker as shown.

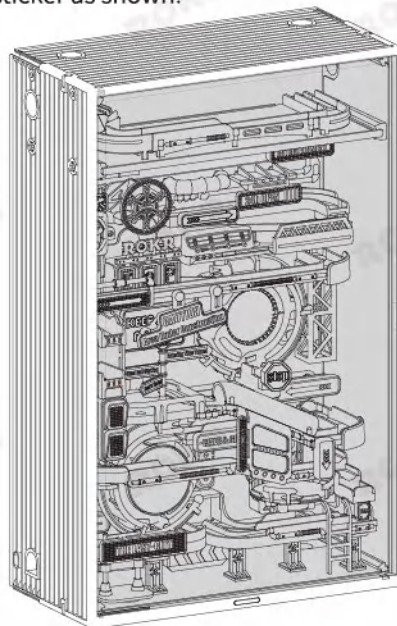

The marble run module is completed.

8

Basic Play
(Assembly instruction for A)

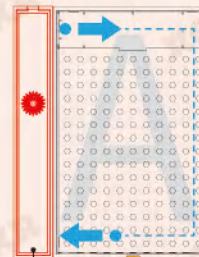

Lift A



(Refer to the assembly instruction of Lift .)



8

<1>

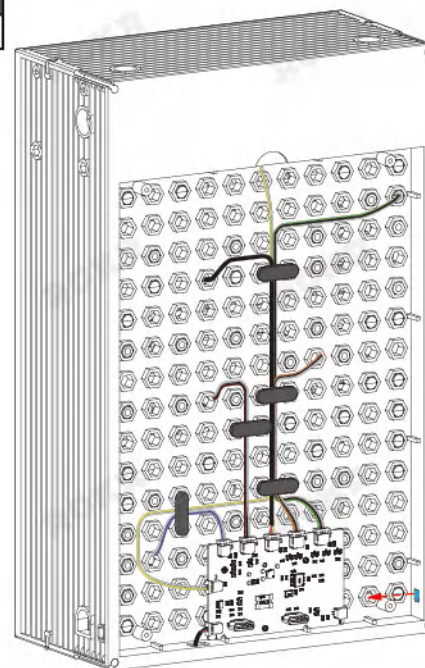

Lift A

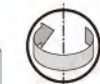

Back side

8

<2>

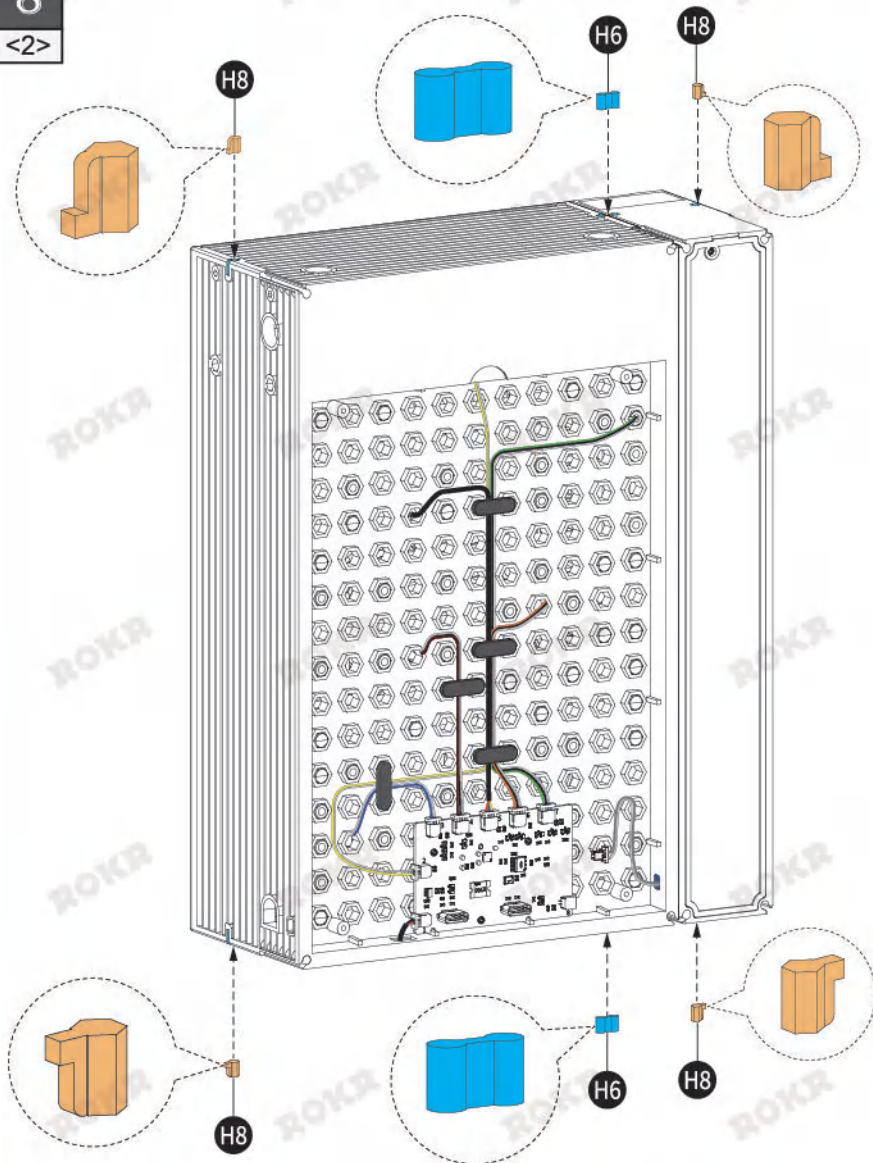

8

<3>

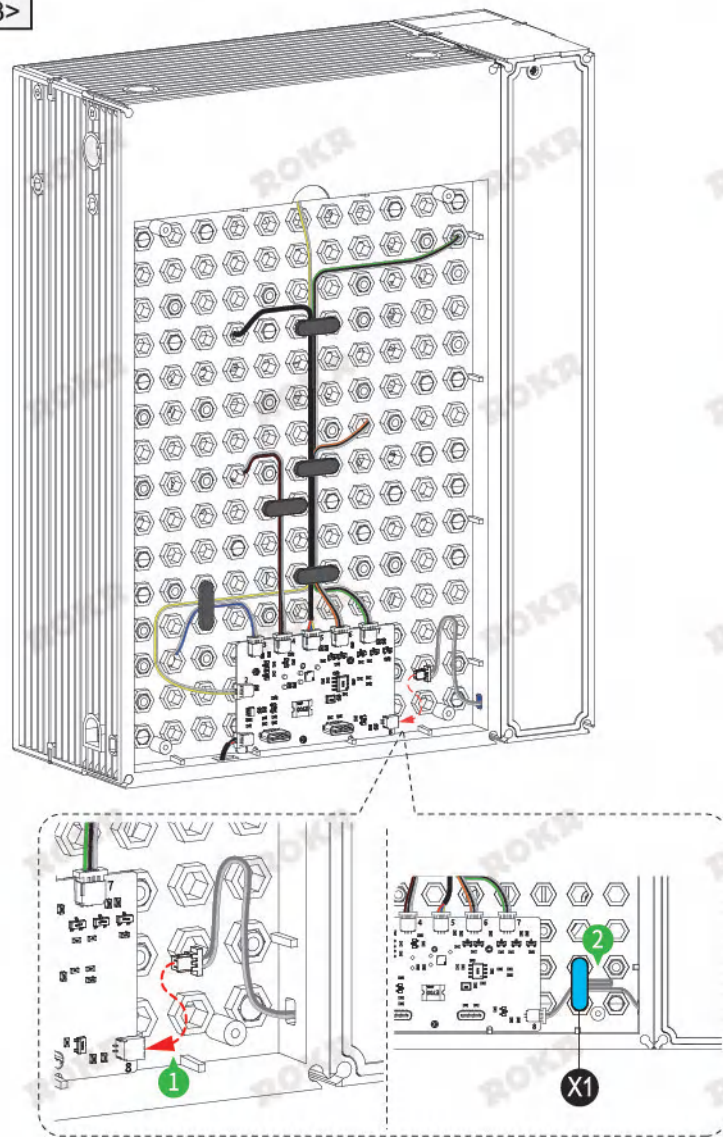

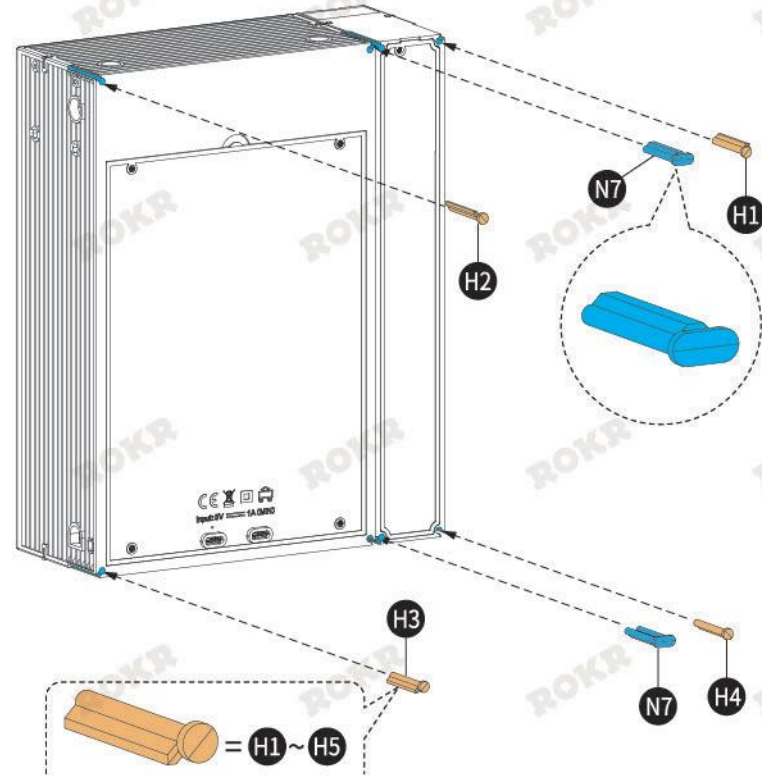
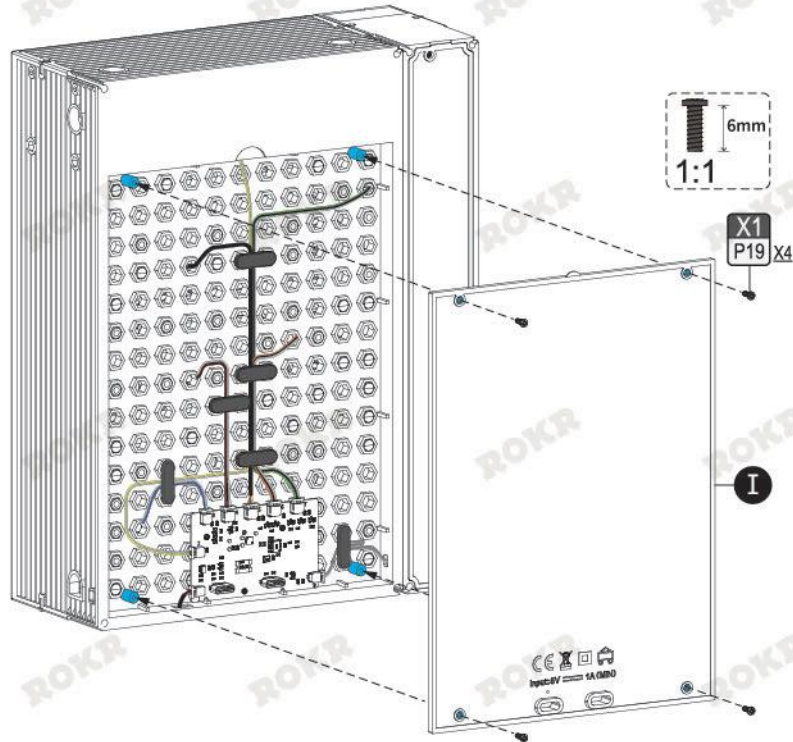

Suggest to use a regular
power adapter.
Input: 5V---2A

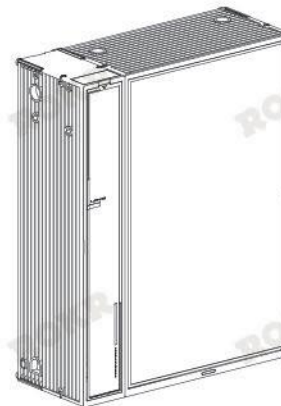

Complete for the basic play.



PARALLEL WORLD

MARBLE RUN

MR01 THE LAST CITY

Attention:

1. 2 modes:

- Marble rolling: The light flashes, the Lift works and marbles begin to run cyclically. It will automatically power off after running for 10 minutes.
- Lighting display: The light flashes, the Lift stops and marbles stop running. It will not automatically power off.

2. Switch on/off:



Touch the button of any marble run module can control all connected modules.

3. Please keep the tool kit of the product well for later maintenance.
4. Keep the remaining parts well for extension playing.



Advanced Play - Module Extension

**ASSEMBLY
INSTRUCTIONS**



Advanced Play - Module Extension Instruction

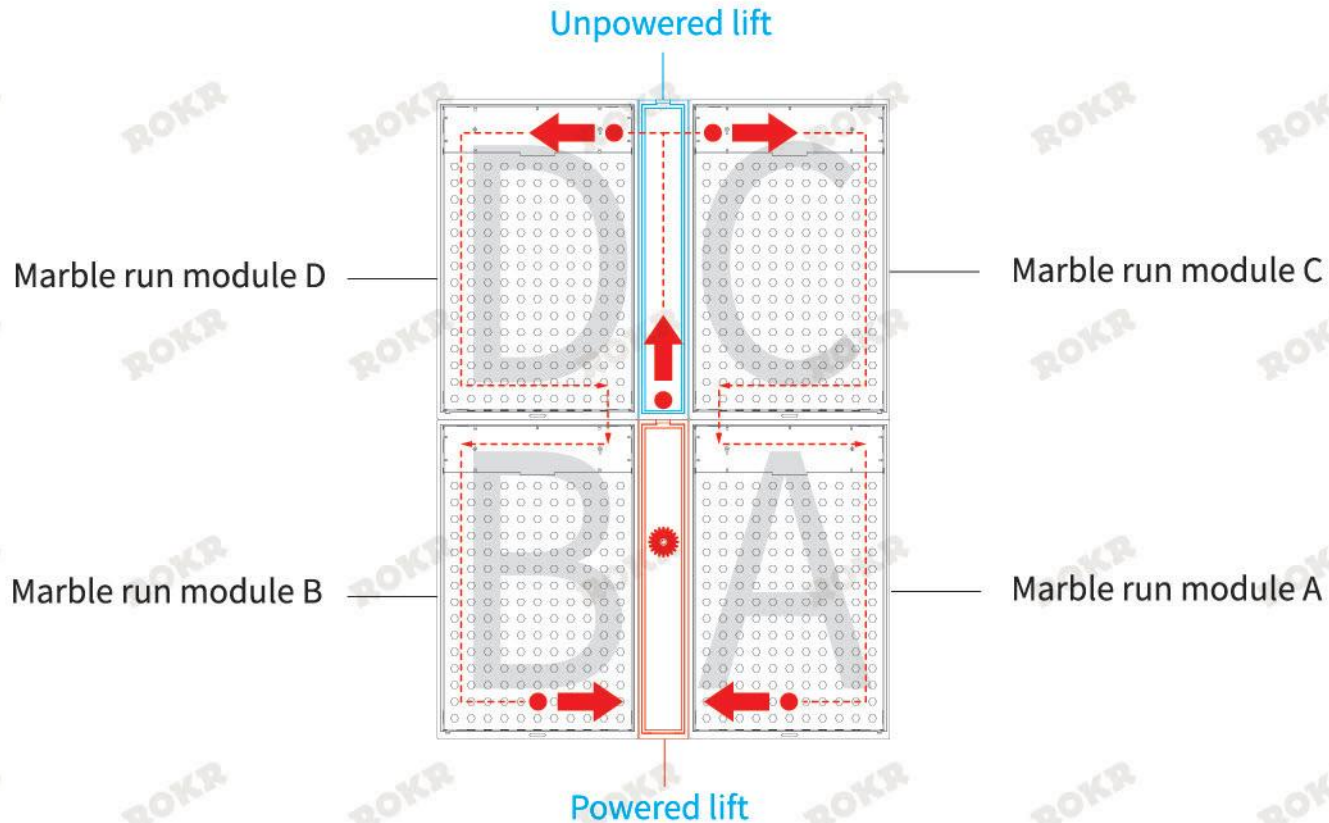

- One system for advanced play includes 2 lift modules and 4 marble run modules as shown.
- Assembling methods for lift and marble run module at different positions are different, please assemble lift and marble run module according to the instruction.

The Last City - Position Switching Instruction for Marble Run Module



Scan for switching position D into position A, B, C

Position D

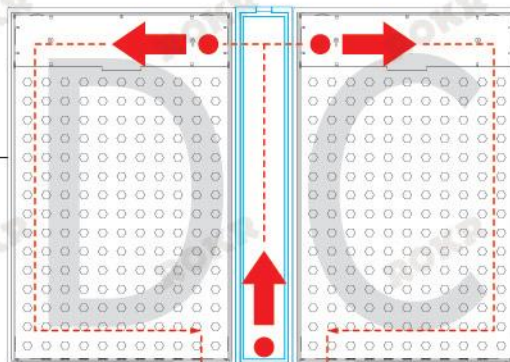

Position C



Scan for switching position C into position A, B, D



Scan for switching position B into position A, C, D

Position B

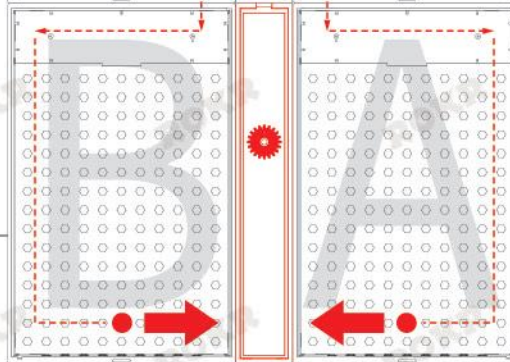

Position A



Scan for switching position A into position B, C, D

Assembly instruction for 5 kinds of common advanced play

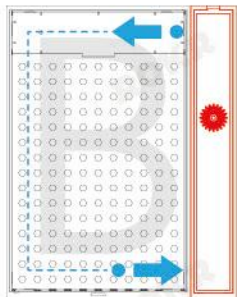

Lift B

➔ **9**
Page 39-40

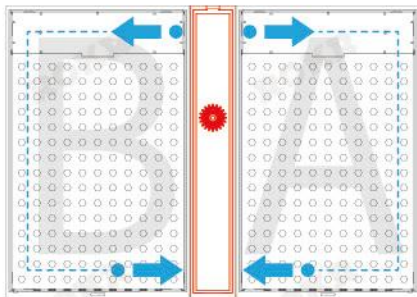

Lift C

➔ **10**
Page 41-42

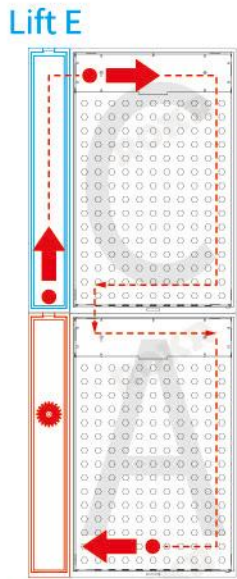

Lift E

Lift D

➔ **11**
Page 43-44

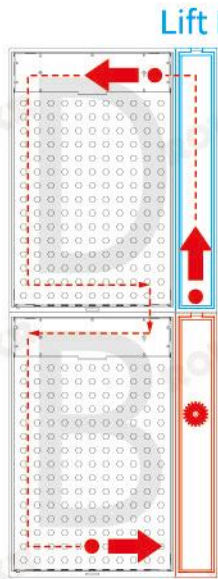

Lift F

Lift D

➔ **12**
Page 45-46

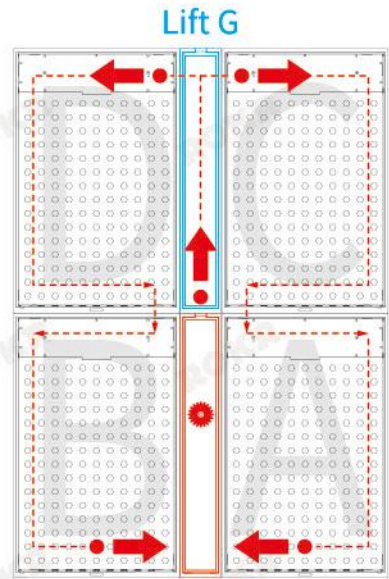

Lift G

Lift D

➔ **13**
Page 47-49

9

Advanced Play - Module Extension (Assembly instruction for B)



Lift B

(Refer to the assembly instruction of Lift)

9

<1>

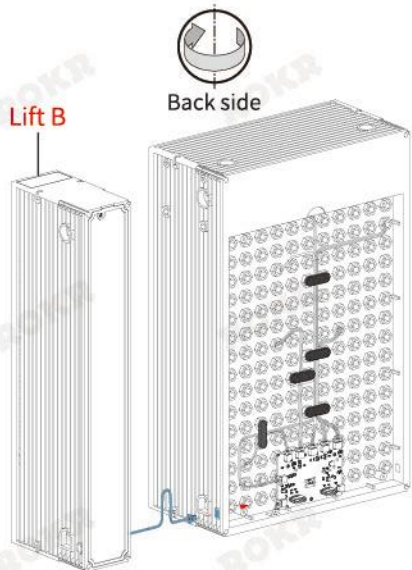

Lift B

Back side

9

<2>

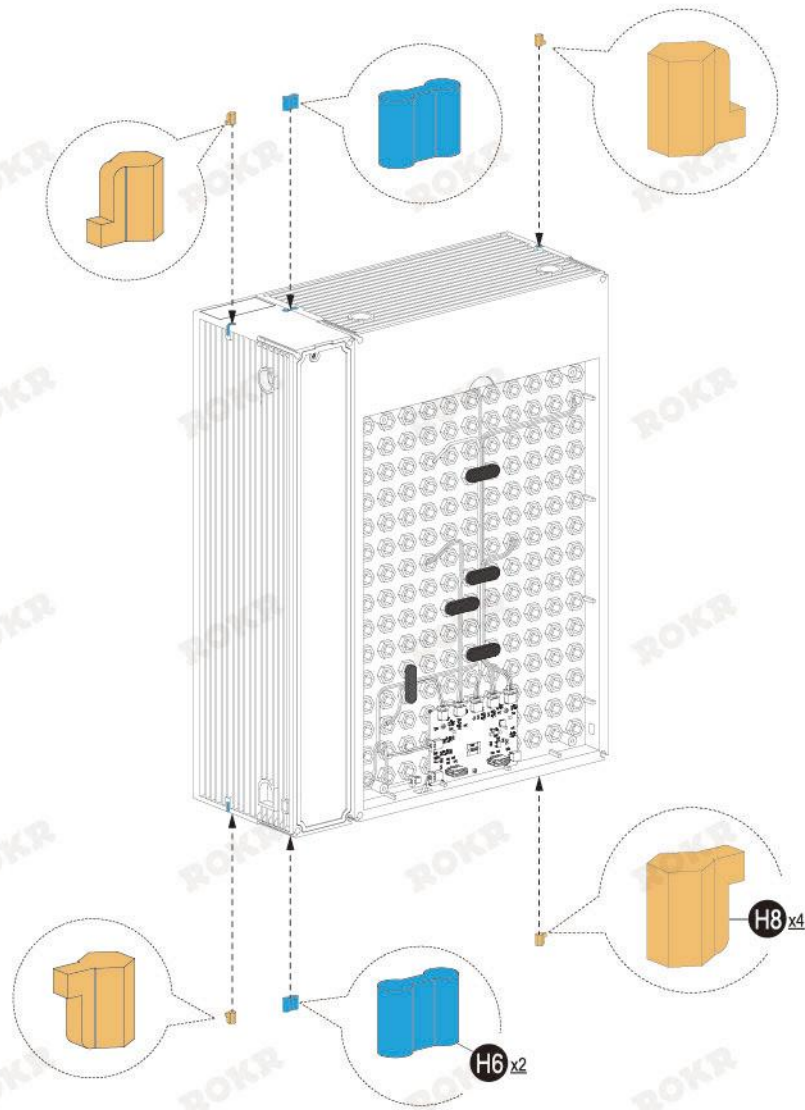

9

<3>

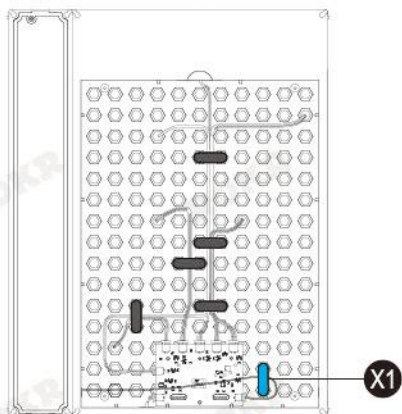
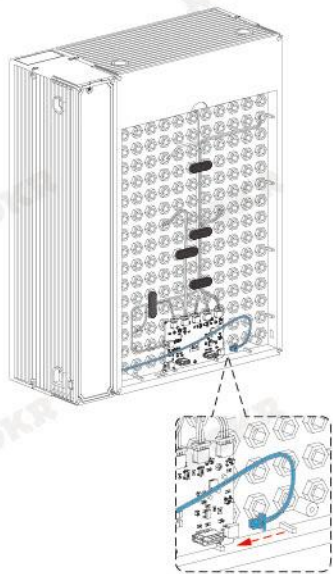

9

<4>

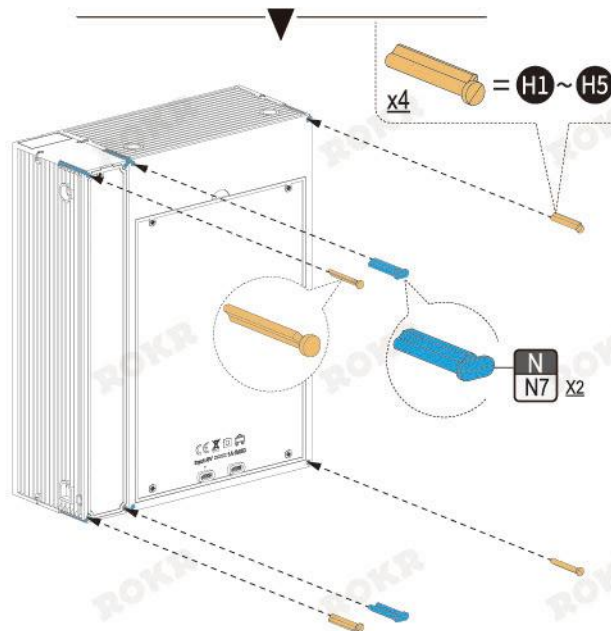
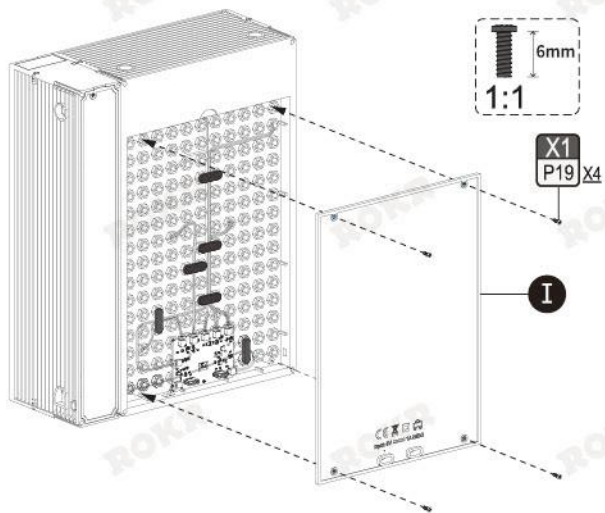

9

<5>



Complete position B

10

Advanced Play - Module Extension
(Assembly instruction for AB)

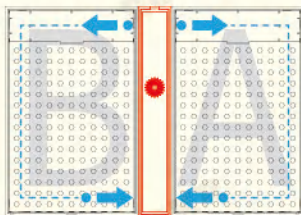

Lift C

(Refer to the assembly instruction of Lift)



Remove and replace corresponding parts of A: (Skip it if no needed.)

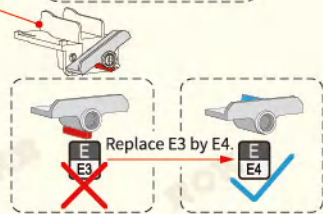
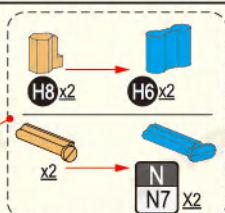

Replace E4 refer to the Lift Instruction



Video for A dismantling/ replacing

10

<1>

Before assembling, put marbles to test.
Do not reverse the positions of left and right modules.



Back side

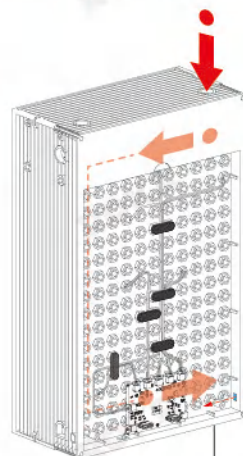

Marble run module A

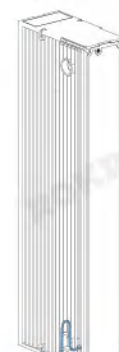

Lift C

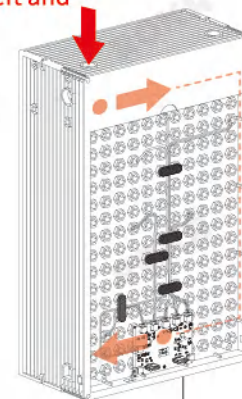

Marble run module B

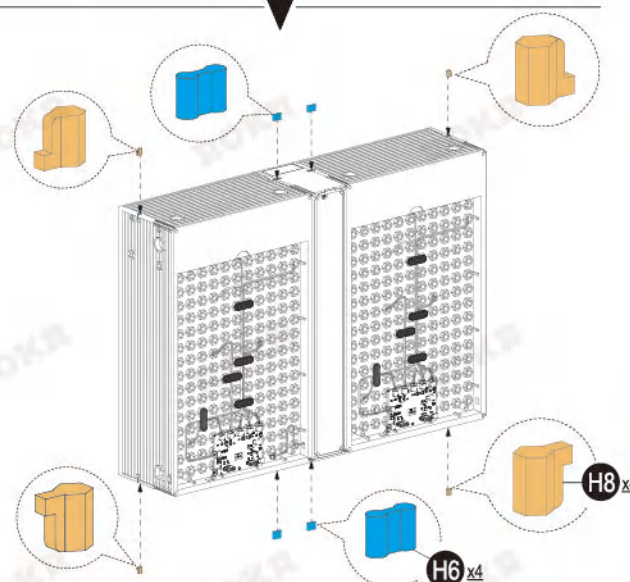

10

<2>

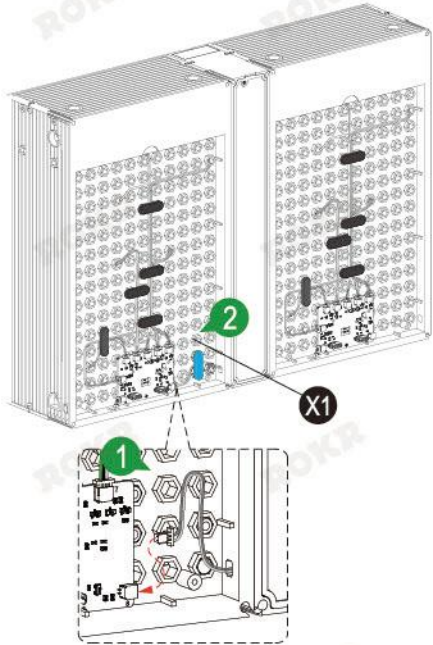

10

<3>

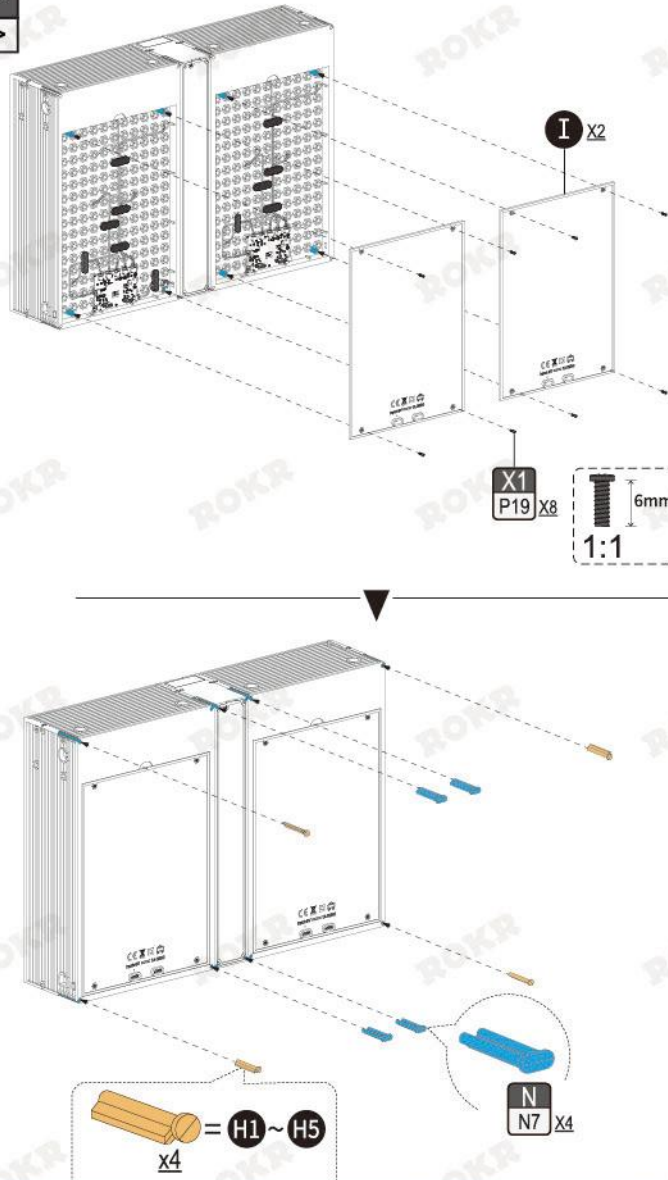

10

<4>

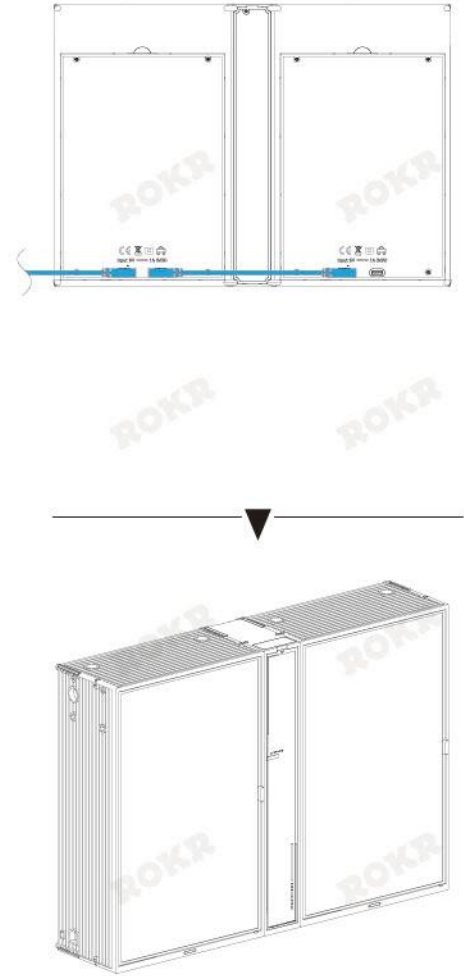

Complete position AB

11

Advanced Play - Module Extension (Assembly instruction for AC)

Lift E

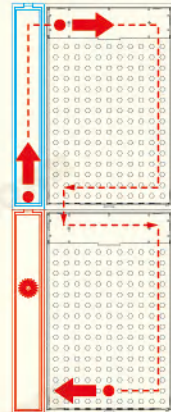

Lift D

(Refer to the **assembly instruction of Lift .**)



Remove and replace corresponding parts of A: (Skip it if no needed.)

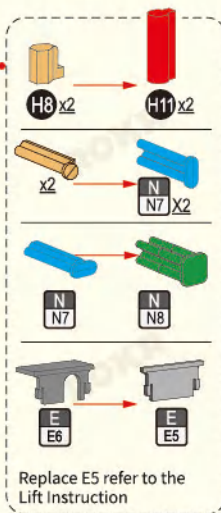
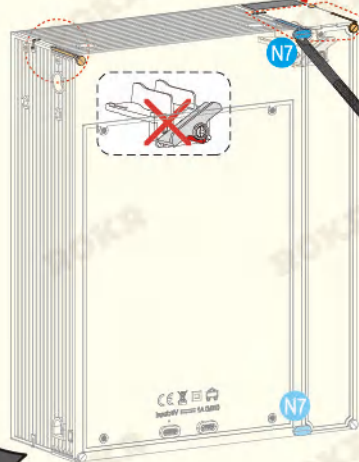

Replace E5 refer to the Lift Instruction

Skip to Step **11** <3> after dismantling.

11

<1>



Check the direction of the track.



Back side

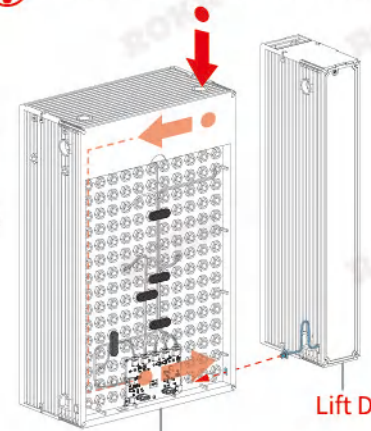

Marble run module A

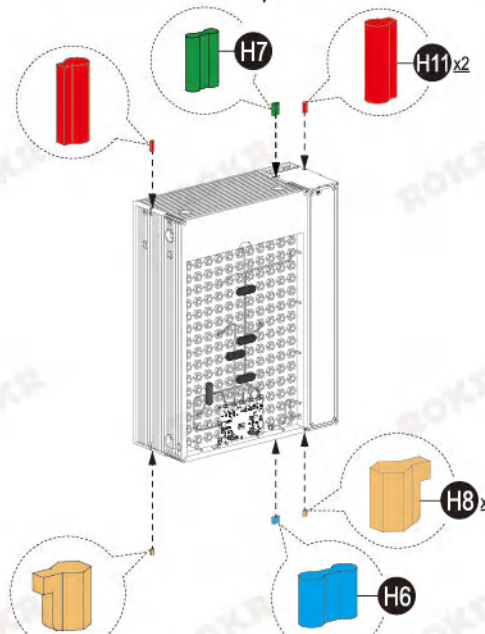

11

<2>

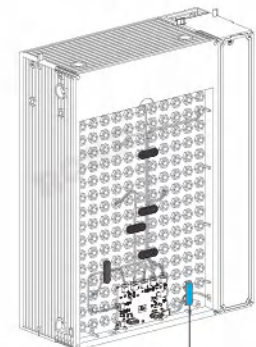
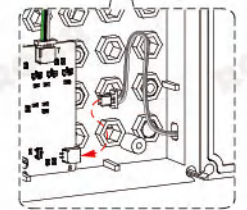
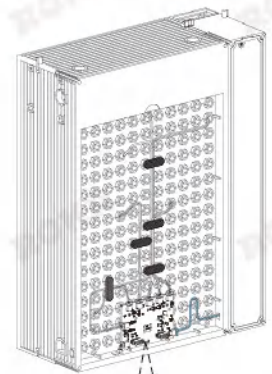

X1

11
<3>

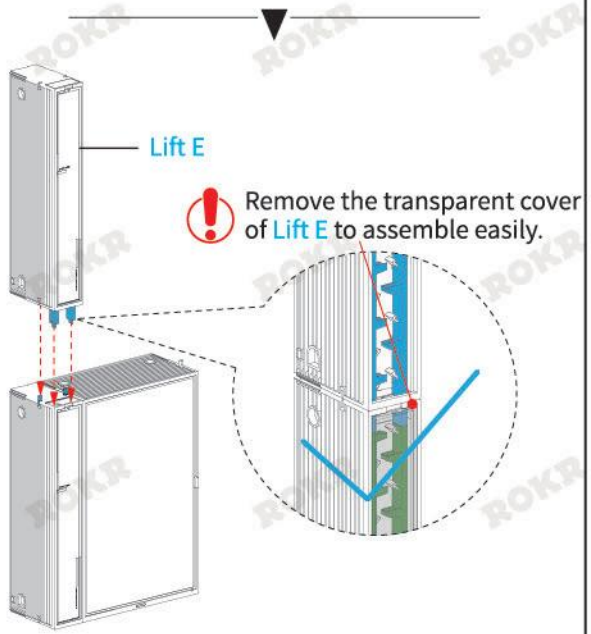
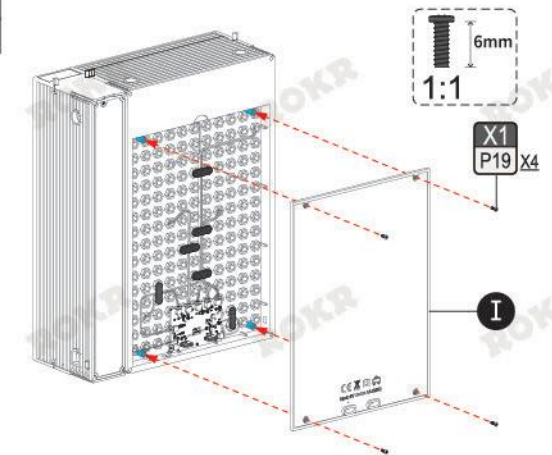

11
<4>

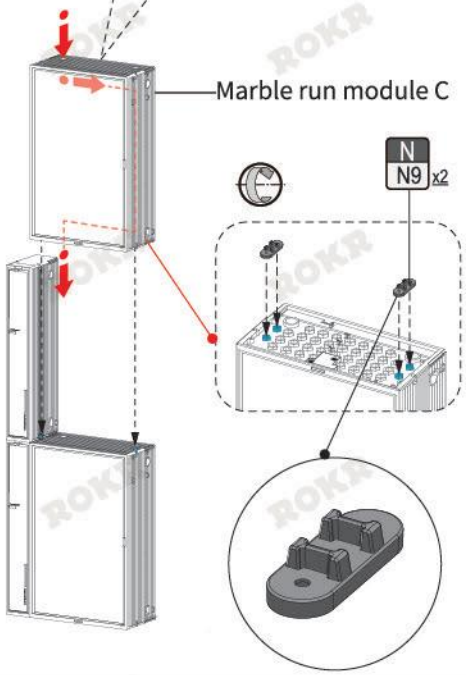
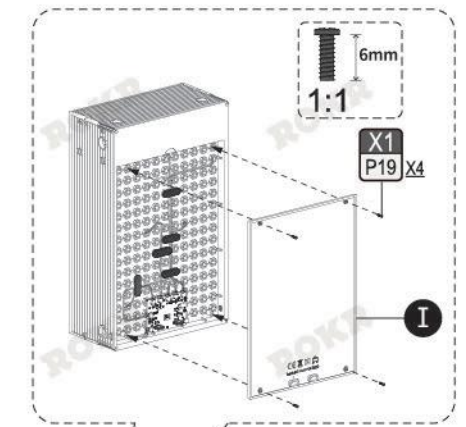

11
<5>

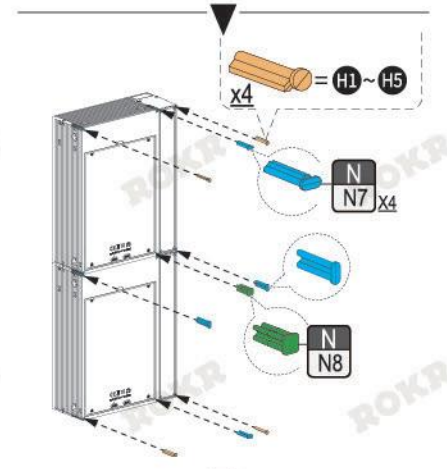

Complete position AC

12

Advanced Play - Module Extension (Assembly instruction for BD)

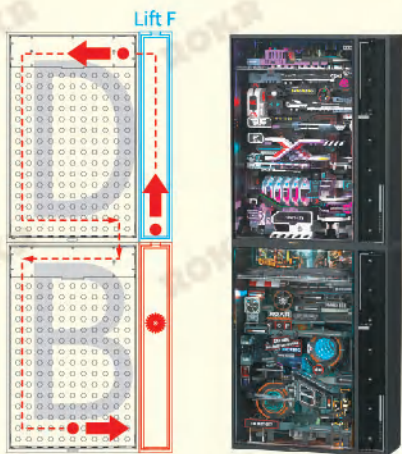

Lift D (Refer to the assembly instruction of Lift.)

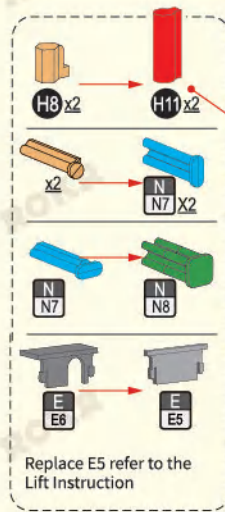

Remove and replace corresponding parts of B: (Skip it if no needed.)

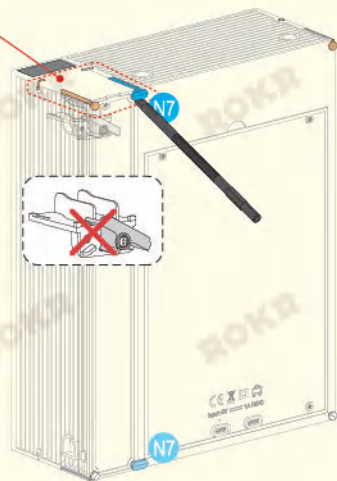

Skip to Step 12
<3> after dismantling.

12

<1>



! Check the direction of the track.

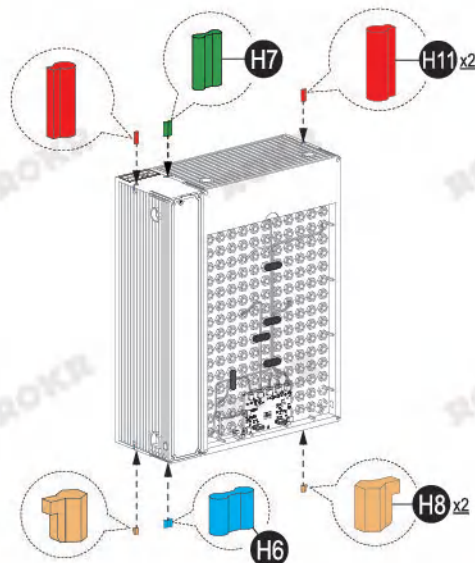
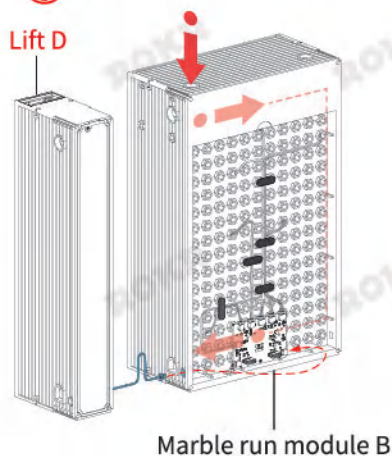

12

<2>

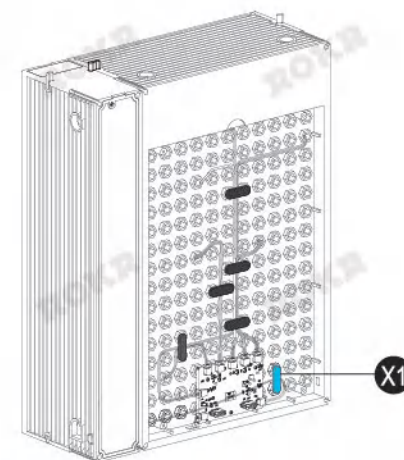
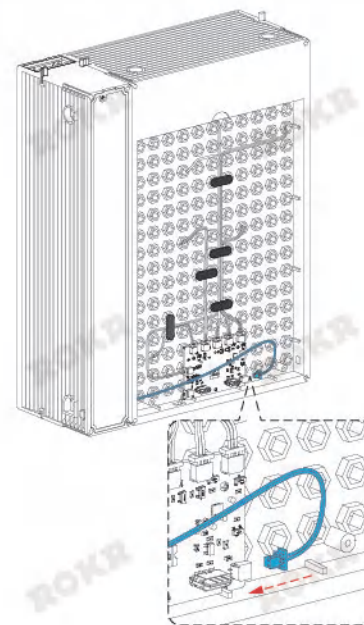

12

<3>

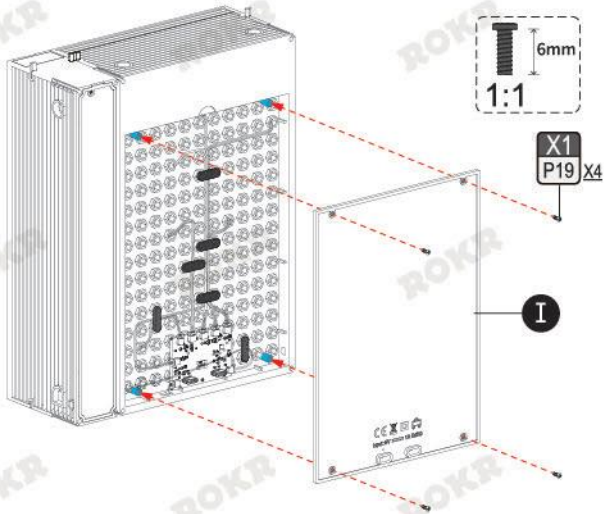

Lift F

Remove the transparent cover of Lift F to assemble easily.

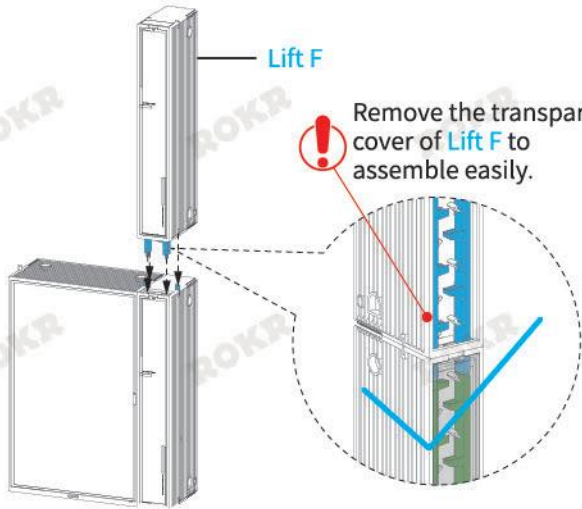

12

<4>

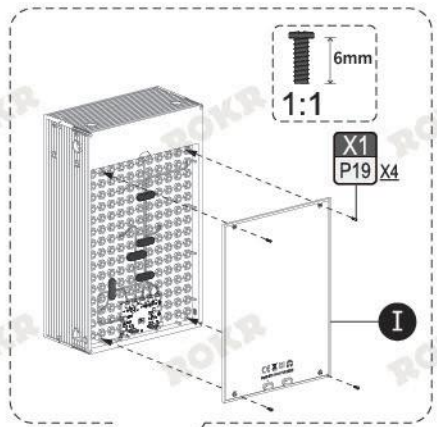

Marble run module D

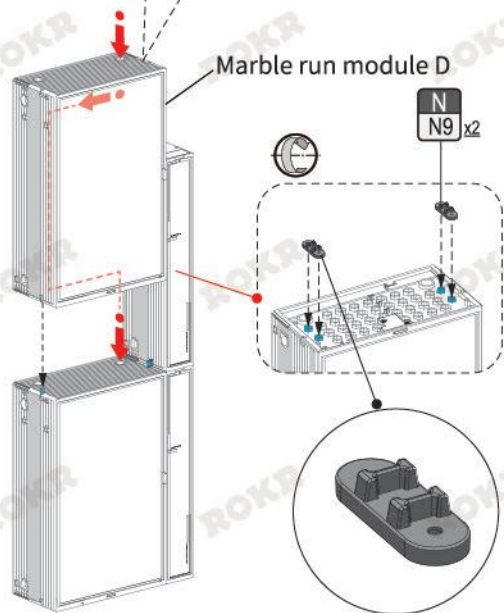

12

<5>

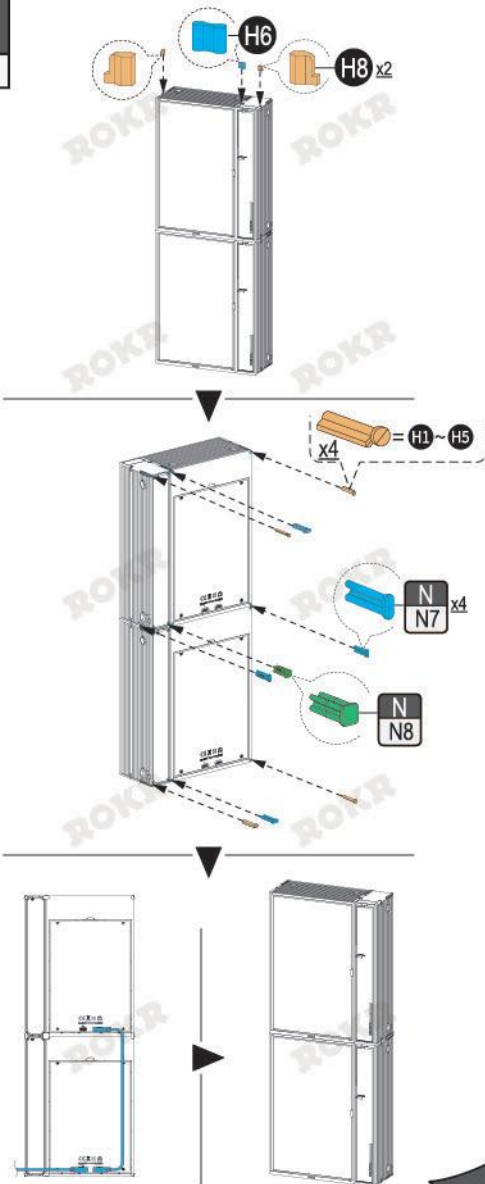

Complete position BD

13

Advanced Play - Module Extension
(Assembly instruction for ABCD)

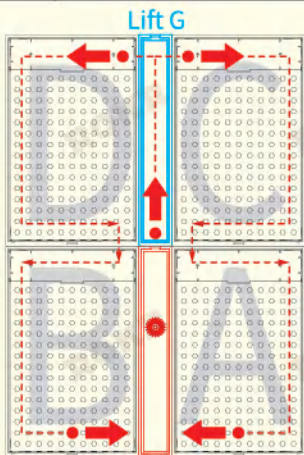

Lift D
(Refer to the assembly instruction of Lift.)

Remove and replace corresponding parts of AB: (Skip it if no needed.)

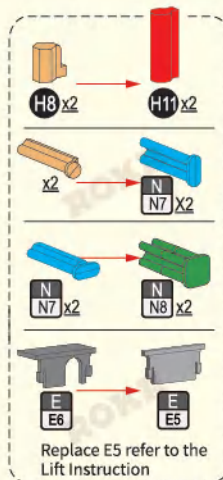
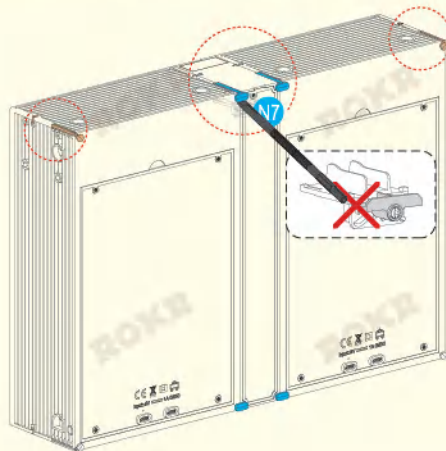

Skip to Step 13 after dismantling.

Remove and replace corresponding parts of AC: (Skip it if no needed.)

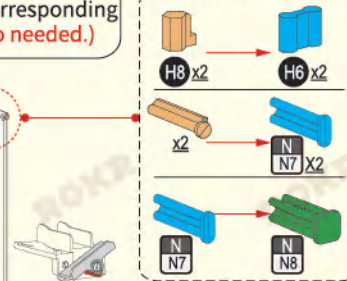

Replace E4 refer to the Lift Instruction



Video for AC dismantling/replacing

13

<1>

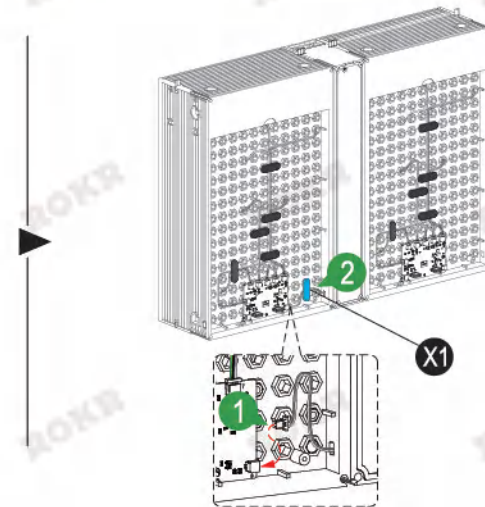
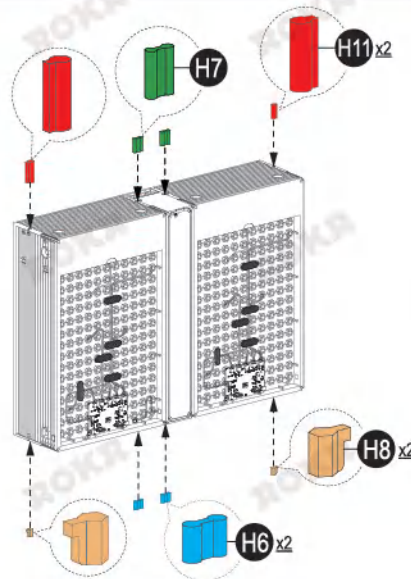
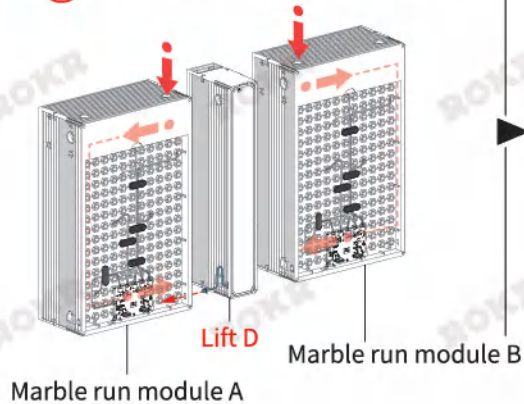

13

<2>

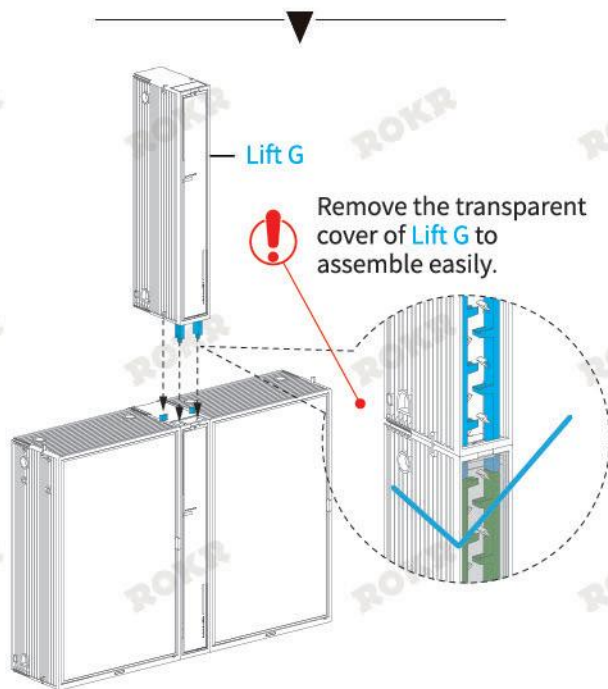
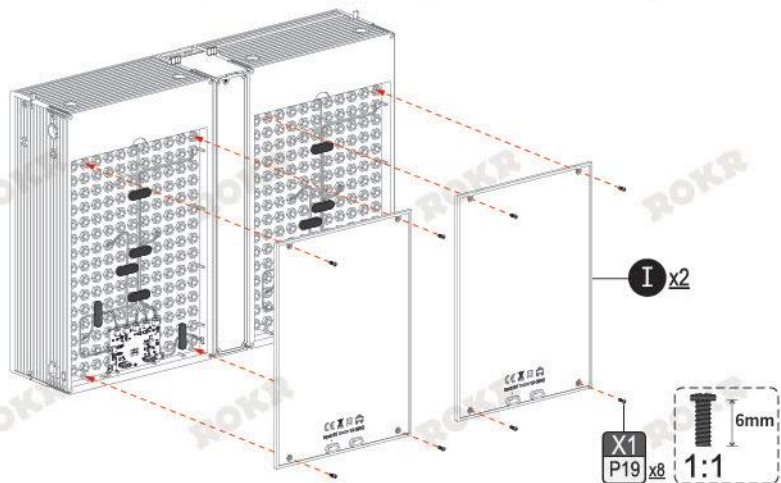

13

<3>

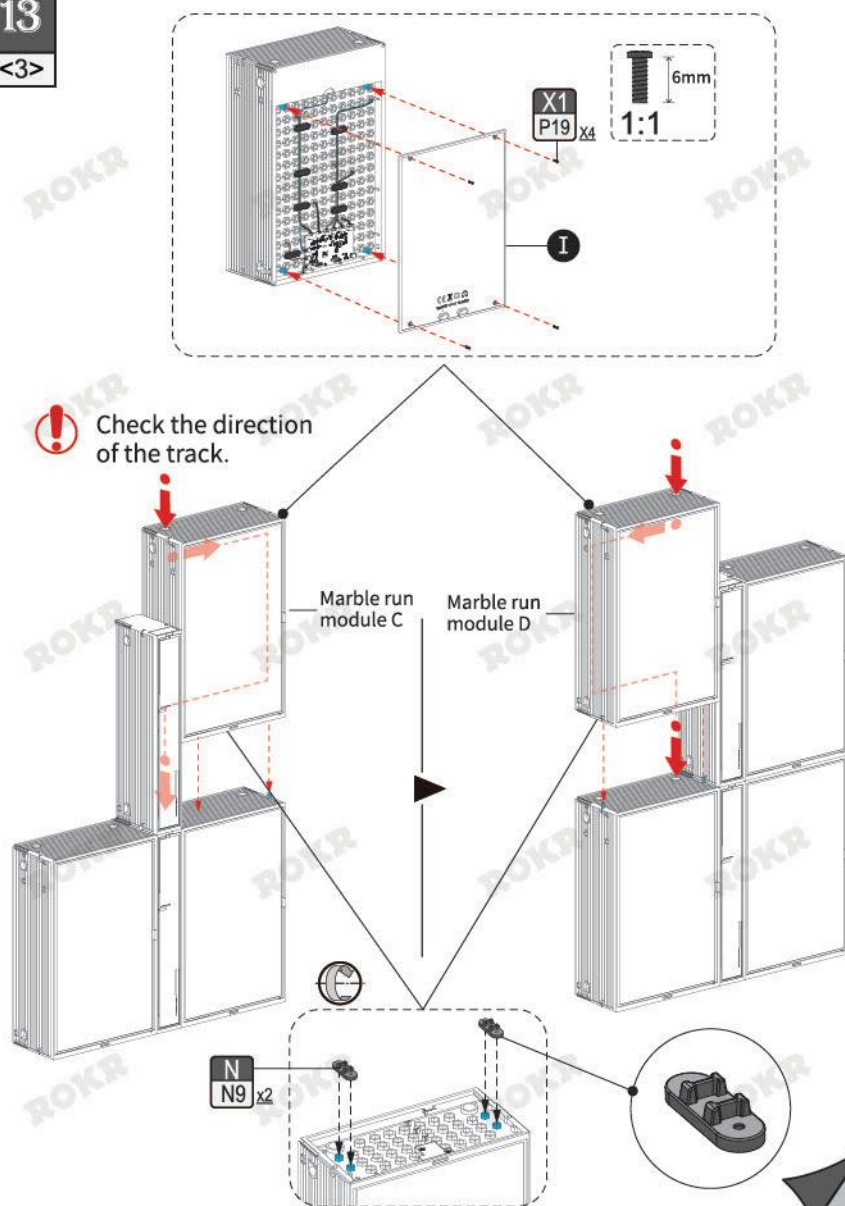

13

<4>

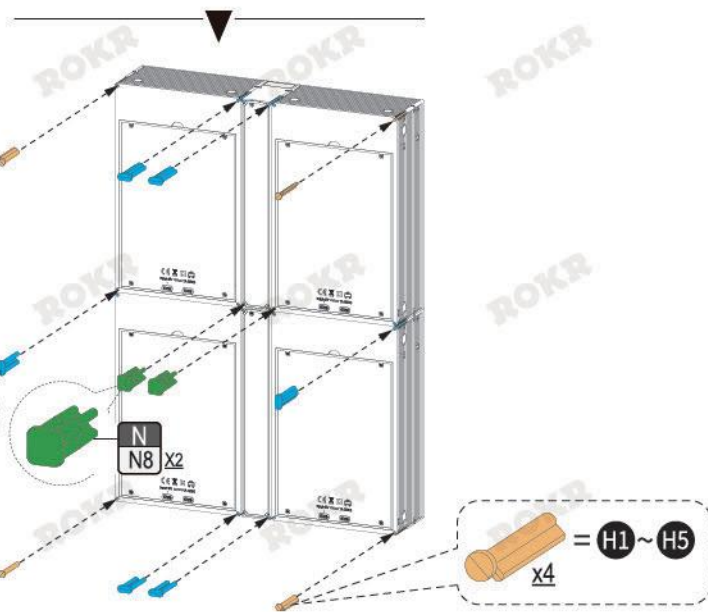
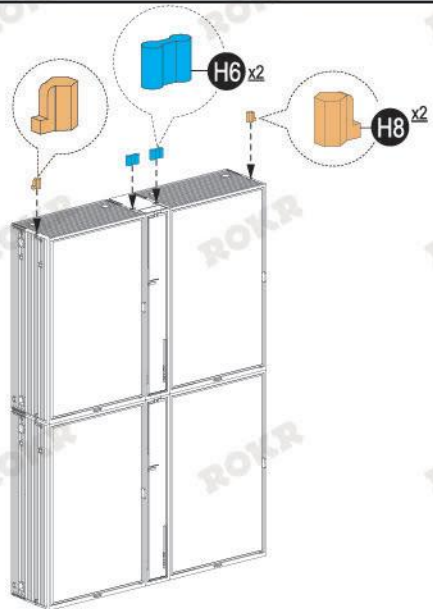

13

<5>

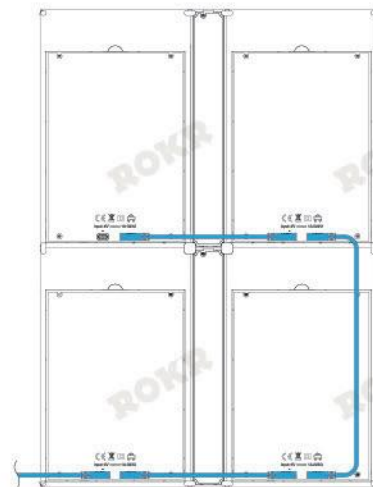

Complete.

MARBLE RUN



Module Swap

Video for dismantling/
replacing in Advanced play

Attention:

- 2 modes:
 - Marble rolling: The light flashes, the Lift works and marbles begin to run cyclically. It will automatically power off after running for 10 minutes.
 - Lighting display: The light flashes, the Lift stops and marbles stop running. It will not automatically power off .

2. Switch on/off:



Touch the button of any marble run module can control all connected modules.

3. Please keep the tool kit of the product well for later maintenance.
4. Keep the remaining parts well for extension playing.





PARALLEL WORLD

MARBLE RUN

MR01 THE LAST CITY



ROKR Facebook



www.robotime.com